

# Heat-Resistant One-Touch Fittings

## Heat-Resistant One-Touch Fittings Straight



RoHS10

### KPMCS

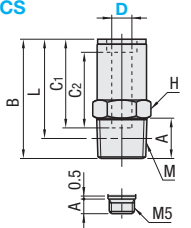

Operating Temperature: 0 ~ 100°C  
Material: Gasket: Hydrogenated Nitrile Rubber

Part Number Type	Nominal D	Thread Size M	B	C1	C2	A	L	Width Across H	Effective Sectional Area (mm <sup>2</sup> )	Mass (g)	Unit Price (1-9 pcs)	Minimum Discount Rate
KPMCS	4	M5	M5x0.8	22.7	17.6	15	3	19.7	10	2	12	10-30
		1	R1/8	23.7			8	19.7		4.5	13	
		2	R1/4	26.7			11	20.7		14	22	
	6	M5	M5x0.8	25.5	19.5	16	3	22.5	12	2	17	10-30
		1	R1/8	25.1			8	21.1		4	14	
		2	R1/4	29.1			11	23.0		14	23	
	8	1	R1/8	29.9	20.2	17	8	25.9	14	11	22.7	10-30
		2	R1/4	28.6			11	22.6		17	25	
		3	R3/8	28.9			12	22.6		17	32	
	10	1	R1/8	33.3	23.2	19.5	8	29.3	17	11	27.3	10-30
		2	R1/4	31.8			12	25.5		17	35	
		3	R1/2	35.8			15	27.6		22	46	
12	2	R1/4	38.9	26.3	23	11	32.9	21	12	28.6	10-30	
	3	R3/8	34.9			12	28.6		21	47		
	4	R1/2	36.9			15	28.7		22	62		

## Heat-Resistant One-Touch Fittings Elbows



RoHS10

### KPMCL

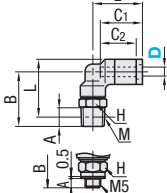

Operating Temperature: 0 ~ 100°C  
Material: Gasket: Hydrogenated Nitrile Rubber

Part Number Type	Nominal D	Thread Size M	A	B	L	C1	C2	E	Width Across H	Effective Sectional Area (mm <sup>2</sup> )	Mass (g)	Unit Price (1-9 pcs)	Minimum Discount Rate
KPMCL	4	M5	M5x0.8	3	19.8	22	17.6	15	20.7	10	1.5	18	10-30
		1	R1/8	8	22.8	24.1					3.5	21	
		2	R1/4	11	25.8	25					9	26	
	6	M5	M5x0.8	3	22	25.3	19.4	16	23	14	1.9	26	10-30
		1	R1/8	8	25	27.3					3.6	28	
		2	R1/4	11	28	28.2					9	36	
	8	1	R1/8	8	28	31.3	20.2	17	24.8	14	17	49	10-30
		2	R1/4	11	31	32.2					16	41	
		3	R3/8	12	32.8	33.7					17	55	
	10	1	R1/8	8	32.5	37.8	23.2	19.5	29.3	17	22.5	67	10-30
		2	R1/4	11	35.5	38.8					30	78	
		3	R3/8	12	38.5	39.5					30	104	
12	2	R1/4	11	37.5	42.3	26.3	23	33.4	21	38	107	10-30	
	3	R3/8	12	38.5	43					39	113		
	4	R1/2	15	41.5	44.1					22	129		

## Heat-Resistant One-Touch Fittings Hex Socket Straight



RoHS10

### KPMCC

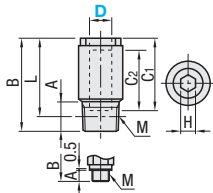

Operating Temperature: 0 ~ 100°C  
Material: Gasket: Hydrogenated Nitrile Rubber

Part Number Type	Nominal D	Thread Size M	B	C1	C2	A	L	Width Across H	Effective Sectional Area (mm <sup>2</sup> )	Mass (g)	Unit Price (1-9 pcs)	Minimum Discount Rate
KPMCC	4	M5	M5x0.8	22.6	17.6	15	3	19.6	2	2	11	10-30
		1	R1/8	23.7			8	19.7		2.5	12	
		2	R1/4	24.7			11	18.7		2.5	19	
	6	M5	M5x0.8	25.5	19.5	16	3	22.5	2	2	15	10-30
		1	R1/8	25.1			8	21.1		4	13	
		2	R1/4	29.1			11	19.4		4	18	
	8	1	R1/8	29.9	20.2	17	8	25.9	5	17	20	10-30
		2	R1/4	28.6			11	22.6		6	23	
		3	R3/8	25.9			12	19.6		6	26	
	10	1	R1/8	33.3	23.2	19.5	8	29.3	5	17	35	10-30
		2	R1/4	32.3			11	26.3		6	33	
		3	R3/8	31.8			12	25.4		6	38	
12	2	R1/4	38.9	26.3	23	11	32.9	8	20	56	10-30	
	3	R3/8	34.9			12	28.6		8	49		
	4	R1/2	36.9			15	28.7		8	64		

## High Heat-Resistant One-Touch Fittings Straight



RoHS10

### KKMCS

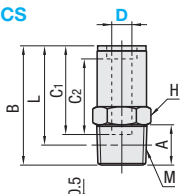

Operating Temperature: 0 ~ 120°C  
Material: Gasket: Fluoro Rubber

Part Number Type	Nominal D	Thread Size M	B	C1	C2	A	L	Width Across H	Effective Sectional Area (mm <sup>2</sup> )	Mass (g)	Unit Price (1-9 pcs)	Minimum Discount Rate
KKMCS	4	M5	M5x0.8	22.7	17.6	15	2.9	19.7	10	2	12	10-30
		1	R1/8	23.7			8	19.7		4.5	13	
		2	R1/4	24.7			11	18.7		2.5	19	
	6	M5	M5x0.8	25.5	19.5	16	3	22.5	12	2	15	10-30
		1	R1/8	25.1			8	21.1		4	13	
		2	R1/4	29.1			11	19.4		4	18	
	8	1	R1/8	29.9	20.2	17	8	25.9	5	17	20	10-30
		2	R1/4	28.6			11	22.6		6	23	
		3	R3/8	25.9			12	19.6		6	26	
	10	1	R1/8	33.3	23.2	19.5	8	29.3	5	17	35	10-30
		2	R1/4	32.3			11	26.3		6	33	
		3	R3/8	31.8			12	25.4		6	38	
12	2	R1/4	38.9	26.3	23	11	32.9	8	20	56	10-30	
	3	R3/8	34.9			12	28.6		8	49		
	4	R1/2	36.9			15	28.7		8	64		

## High Heat-Resistant One-Touch Fittings Elbows



RoHS10

### KKMCL

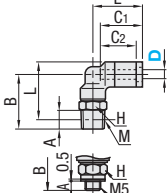

Operating Temperature: 0 ~ 120°C  
Material: Gasket: Fluoro Rubber

Part Number Type	Nominal D	Thread Size M	A	B	L	C1	C2	E	Width Across H	Effective Sectional Area (mm <sup>2</sup> )	Mass (g)	Unit Price (1-9 pcs)	Minimum Discount Rate
KKMCL	4	M5	M5x0.8	3	19.8	22	17.6	15	20.7	10	1.5	18	10-30
		1	R1/8	8	22.8	24.1					3.5	21	
		2	R1/4	11	25.8	25.3					9	26	
	6	M5	M5x0.8	3	22	25.3	19.4	16	23	12	1.9	26	10-30
		1	R1/8	8	25	27.3					3.6	28	
		2	R1/4	11	28	28.2					9	36	
	8	1	R1/8	8	28	31.3	20.2	17	24.8	14	17	49	10-30
		2	R1/4	11	31	32.2					16	41	
		3	R3/8	12	32.8	33.7					17	55	
	10	1	R1/8	8	32.5	37.8	23.2	19.5	29.3	17	22.5	67	10-30
		2	R1/4	11	35.5	38.8					30	78	
		3	R3/8	12	38.5	39.5					30	104	
12	2	R1/4	11	37.5	42.3	26.3	23	33.4	21	38	107	10-30	
	3	R3/8	12	38.5	43					39	113		
	4	R1/2	15	41.5	44.1					22	129		

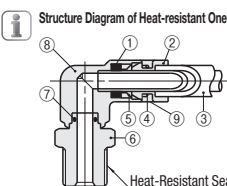

Ordering Example: Part Number - Nominal  
KPMCS6 - 1

No.	Name of Parts	Material
①	Elastic Sleeve	HNBR, FKM
②	Release Ring	Brass - Electroless Nickel Plating
③	Tubes	Sputtering Resistant Tubes
④	Guide Ring	Brass - Electroless Nickel Plating
⑤	Lock Pawl	Stainless Steel
⑥	Thread Body	Brass - Electroless Nickel Plating
⑦	O-Rings	H-NBR, FKM
⑧	Metal Body	Brass - Electroless Nickel Plating
⑨	Cover	Brass - Electroless Nickel Plating

### Specifications

Type	Heat Resistant	Super Heat Resistant
Applicable Fluid	Air, Water	
Operating Temperature Range*	0~100°C	0~120°C
Max. Operating Pressure	1.0MPa	
Operating Vacuum Level	-100kPa	

\* No Freezing

\*When using with water, keep the surge pressure to below max. pressure rating. For water, inlets for Soft Tubes (P1390 PUIT / PUSIT) must be used.

\*When using Sputter Proof Tubes, peel back outer insulation to C2 dimension. Non-insulated tubes can be also used.