

# Globe Valves / Check Valves / Strainers / Hydraulic Valves

## Globe Valves

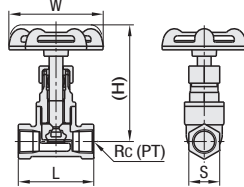

Type	Material	Max. Operating Pressure
<b>GBUCL</b>	Main Body: SCS13A Gasket: 8A - 15A PTFE 20A - 25A Expanded Graphite + PTFE Braided	Water, Oil, Air: 1.0MPa



## Check Valves



RoHS 10

Type	Material	Max. Operating Pressure
<b>THKB</b>	Main Body: SCS13A Gasket: Non-asbestos Sheet	Water, Oil, Air: 0.6MPa

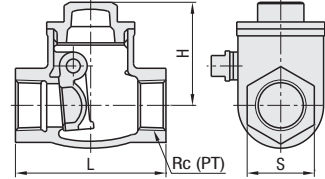

Part Number		Rc (PT)	S	L	(H)	W	GBUCL	
Type	No.						Unit Price	Volume Discount Rate
							1 ~ 4 pc(s).	5~10
<b>GBUCL</b>	8A	1/4	18	44	68	55		
	10A	3/8	22	48	68	55		
	15A	1/2	26	52	68	55		
	20A	3/4	34	60	93	60		
	25A	1	41	72	100	70		

Part Number		Rc (PT)	S	L	H	THKB	
Type	No.					Unit Price	Volume Discount Rate
						1 ~ 4 pc(s).	5~10
<b>THKB</b>	15A	1/2	29	65	45		
	20A	3/4	35	80	55		
	25A	1	44	90	61		

### Features

- S-shaped flow valve with bulkhead inside body, positioning the center of inlet and outlet in straight line.

### Features

- Flexible structure that can be used by hanging one end of disc in hinge shape. In addition to horizontal piping, it can be used in vertical piping.
- The smooth fluid design reduces pressure losses.

## Strainers



RoHS 10

Type	Material	Max. Operating Pressure
<b>STRY</b>	Main Body: SCS13A Gasket: PTFE (With Filler)	Water, Oil, Air: 0.6MPa

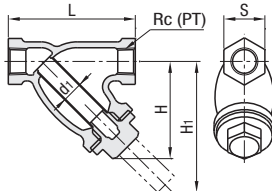

Part Number		Rc (PT)	S	L	H	H1	d1	STRY	
Type	No.							Unit Price	Volume Discount Rate
								1 ~ 4 pc(s).	5~10
<b>STRY</b>	8A	1/4	21	65	50	67	15		
	10A	3/8	23	70	50	68	15		
	15A	1/2	29	85	60	80	18		
	20A	3/4	35	100	65	90	23		
	25A	1	43	115	77	107	30		

### Features

- Separates and removes foreign objects or dust in fluids.
- Mesh size is 40.

## Hydraulic Valves

### Inline Flow Control Valves



Type	Material	Applicable Fluids	Operating Temp.	Max. Operating Pressure
<b>BKFS</b>	Main Body: Steel	Common Mineral Operational Oil	-10~60°C	34.5MPa

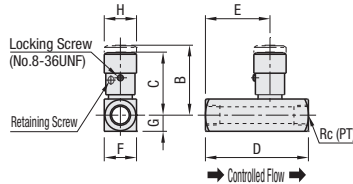

### Check Valves



Type	Material	Applicable Fluids	Operating Temp.	Max. Operating Pressure
<b>BCKB</b>	Main Body: Steel	Common Mineral Operational Oil	-10~60°C	34.5MPa

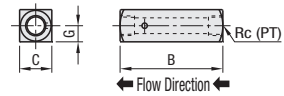

Cracking Pressure=0.04MPa

Part Number		Rc (PT)	Max. Flow	B	C	D	E	F	G	H	Mass (g)	BKFS	
Type	No.											Unit Price	Volume Discount Rate
												1 ~ 4 pc(s).	5~10
<b>BKFS</b>	8A	1/4	192/min	45.5	41	67	42	21	10.5	21	220		
	10A	3/8	302/min	56.5	49.5	70	44.5	25	12.5	25	365		
	15A	1/2	572/min	70	61	87.5	57	32	16	30	690		

Part Number		Rc (PT)	Max. Flow	B	C	G	Mass (g)	BCKB	
Type	No.							Unit Price	Volume Discount Rate
								1 ~ 4 pc(s).	5~10
<b>BCKB</b>	8A	1/4	192/min	67	21	10.5	170		
	10A	3/8	302/min	70	25	12.5	260		
	15A	1/2	572/min	87.5	32	16	510		

### Features

- Fine adjustments at low flow rate possible by 3 initial turns of the knob with a step needle.
- Flow rate setup time can be reduced by using the colorings as a guide.

### Features

- Prevents reflux by integrating this valve into hydraulic circuit.



Ordering Example

Part Number  
**GBUCL10A**