

Stainless Steel Detachable Hinges

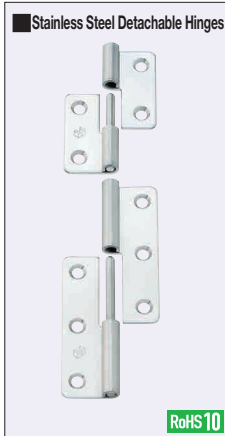

SHHPSL (For Left-hand Use)

SHHPSR (For Right-hand Use)

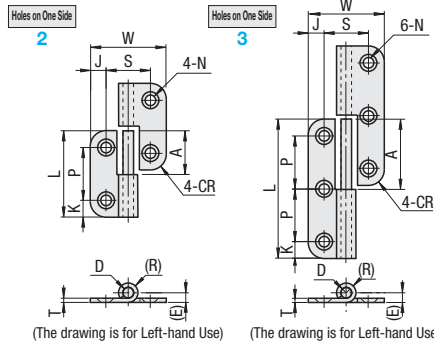

SHHPSLC (For Left-hand Use) (Short Shaft Type)

SHHPSRC (For Right-hand Use) (Short Shaft Type)

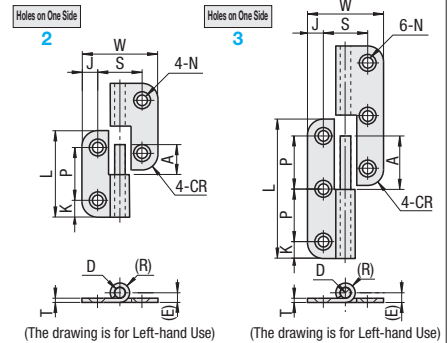

Material: SUS304

Part Number Type	Holes on One Side No.	* Allowable Load		Mass (g)	L	W	SHHPSL SHHPSR	SHHPSLC SHHPSRC	K	P	J	S	N		T	(E)	(R)	CR	D	Unit Price 1 - 8 pc (s)	Volume Discount Rate 9 - 100	
		kg	N										Through	Countersink								
SHHPSL SHHPSLC (For Left-hand Use)	5	2	9	88	34	41	19	14	8	25	7.5	21	5.5	8.6 (For M4 Screw)	2	4.6	4.6	4	5			
		3	11	108	55	66	31	26														
SHHPSR SHHPSRC (For Right-hand Use)	6	2	12	117	49	48	22	17	9	30	8	32	6.5	10.6 (For M5 Screw)	3	6.1	6.1	5	6			
		3	15	147	80	78	37	32														
	8	2	25	245	111	59	29	24	11	37	10	42	6.5									
		3	38	372	185	96	47	42														
	845	2	30	294	162	70	34	29	13.5	43	16.5	47										
		3	40	392	266	113	56	51														

* The allowable load is the value when 2 pieces are used.

Ordering Example: **Part Number** - Holes on One Side
SHHPSL5 - 3



Example

SHHPSLC (Short Shaft Type)

SHHPSL

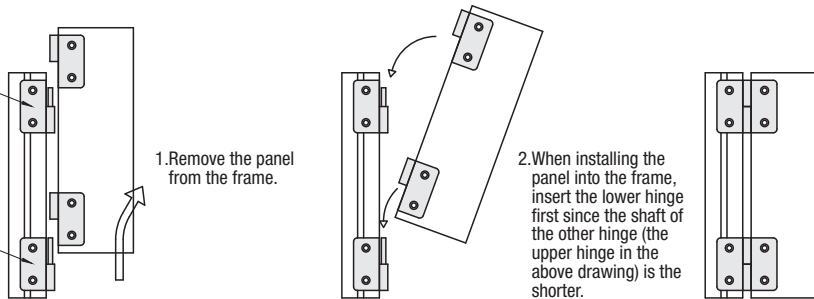

HNS2L (Left Door Type)

HNS2R (Right Door Type)

The drawings are for Right Door Type.

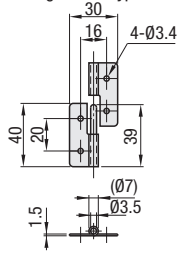

HNS3L (Left Door Type)

HNS3R (Right Door Type)

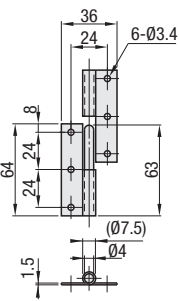

HNS4L (Left Door Type)

HNS4R (Right Door Type)

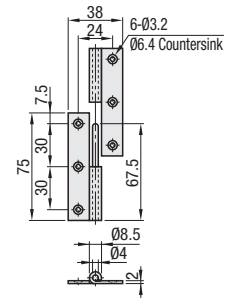

Material: SUS304

The Right Door Type has a door on the right side.

Part Number Type	* Allowable Load (N)	Weight (g)	Unit Price 1 - 19 pc (s)	Volume Discount Rate 20 - 99	Volume Discount Rate 100 - 200
HNS2L HNS2R	48	21			
HNS3L HNS3R	68	44			
HNS4L HNS4R	147	65			



Ordering Example: **Part Number**
HNS2L

* The allowable load is the value when 2 pieces are used.