

Urethane, Rubbers

Piloted Type

Bumpers with pilot tip ends are available in a short delivery time.



Standard	Configurable Type	Material	Hardness	Color
DXSK	DXFS	Ether Polyurethane	Shore A95	Natural Color
DXHK	DXFH		Shore A90	Natural Color
DXMK	DXFM	Ester Polyurethane	Shore A70	Natural Color
DXLK	DXFL		Shore A50	Natural Color
-	RBKN	Nitrile Rubber (NBR)	Shore A70	Black
-	RBKC	Chloroprene Rubber (CR)	Shore A65	Black
-	RBKU	Low Elasticity Rubber (HAINITE® GP-3SL5)	Shore A35	Black
-	RBKS	Silicon Rubber (SI)	Shore A70	Light Gray
-	RBKA		Shore A50	Milky White
-	RBKF	Fluororubber (FPM)	Shore A80	Black

The milky white color of silicone rubber shore A 50 is translucent.

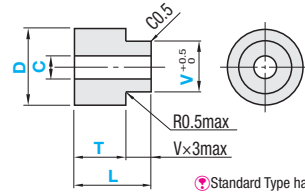

T Tolerance

T	Urethane	Rubber
30 or Less	±0.2	±0.3
31 ~ 50	±0.3	-

D Tolerance

D	Urethane	Rubber
40 or Less	±0.2	±0.5
41-60	±0.3	±0.7
61-100	±0.4	-

C Tolerance

C	Urethane	Rubber
40 or Less	+0.2 0	+1.0 0
41 or More	+0.3 0	+1.4 0

RoHS 10

Standard Type (No Hole Type)

Part Number	Selection			Unit Price				
	D	V Selection	T Selection	L Selection	DXSK	DXHK	DXMK	DXLK
DXSK (Shore A95) DXHK (Shore A90) DXMK (Shore A70) DXLK (Shore A50)	8	5	3 5	8 10				
			8 10	13 15				
	10	5 8	3 5	9 11 13				
			8 10 15	14 16 18 21 23				
	15	8 10	3 5	11 13 15				
			8 10 15	16 18 20 23 25				
	20	10 15	5 8 10 15	15 18 20 23 25				
			15 20	25 30 35				
	25	15 20	5 10	15 20 25				
			15 20 25	25 30 35 40				
	30	15 20	5 10	15 20 25				
			15 20 25	25 30 35 40				
40	20 30	5 10	15 20 25					
		15 20 25	25 30 35 40					
50	20 30	5 10	15 20 25					
		15 20 25	25 30 35 40					
60	30 40	5 10	15 20 25					
		15 20 25	25 30 35 40					



Ordering Example

Part Number	V	T	L
DXHK20	- 10	- 10	- 18

Urethane Configurable (Hole Configurable Type)

Part Number	1mm Increment					Unit Price			
	D	V (V<D)	T	L	C	DXFS	DXFH	DXFM	DXFL
DXFS (Shore A95)	6-15	3-14	2-30	4-10	0 (No Hole)				
				11-25					
				26-40					
				41-50					
DXFH (Shore A90)	16-30	6-29	5-40	7-10	2-40				
				11-25					
				26-40					
DXFM (Shore A70)	31-45	10-44	5-40	7-10	0 (No Hole)				
				11-25					
				26-40					
DXFL (Shore A50)	46-60	15-59	5-45	7-10	10-55				
				11-25					
				26-40					
				41-50					

C≤V-4 L-T≤Vx3

For Urethane Configurable Type, configurable dimension range has been shortened.

Rubber Configurable (Hole Configurable Type)

Part Number	1mm Increment					Unit Price					
	D	V (V<D)	T	L	C	RBKN	RBKC	RBKU	RBKS	RBKA	RBKF
RBKN Nitrile Rubber (NBR)	6-15	3-14	2-30	4-10	0 (No Hole)						
				11-20							
RBKC Chloroprene Rubber (CR)	16-30	6-29	5-40	21-30	2-40						
				31-50							
				7-10							
RBKU Low Elasticity Rubber	31-45	10-44	5-30	11-20	0 (No Hole)						
				21-30							
				31-50							
RBKS (Shore A70) Silicon Rubber (SI)	46-60	15-59	5-30	7-10	10-50						
				11-20							
				21-30							
RBKA (Shore A50) Silicon Rubber (SI)	46-60	15-59	5-30	31-50	10-50						
				7-10							
RBKF Fluororubber (FPM)	46-60	15-59	5-30	11-20	10-50						
				21-30							
				31-50							

C≤V-4 L-T≤Vx3

L≤30 for RBKU, RBKS and RBKF.



Ordering Example

Part Number	D	V	T	L	C
DXFL	- D49	- V30	- T6	- L42	- C0