

# Thumb Screws (Plastic Head) / Plastic Hex Spacers

## Both Ends Tapped

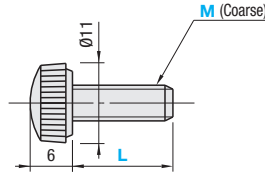

**CRKW** (White)  
**CRKB** (Black)  
**CRKR** (Red)



**M** Material Knurled Head: PC (Polycarbonate) screw SUSXM7

Part Number		Unit Price	Volume Discount Rate
Type	M-L	1 ~ 99 pc(s).	100 ~ 500 pcs.
<b>CRKW</b> (White) <b>CRKB</b> (Black) <b>CRKR</b> (Red)	3- 6		
	8		
	10		
	12		
	15		
	20		
	4- 6		
	8		
	10		
	12		
	15		
	20		



Ordering Example

Part Number  
**CRKW3-6**

• Usable as screws for cover attachment.



**PEKP**

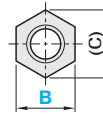
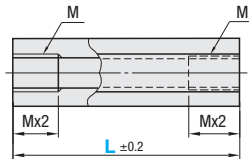

<Cautions>

- The surface color may change depending on production lot and other conditions.
- For material data, see **P221**.
- The pilot hole for tapping goes through.

**M** Material: PEEK (Polyetheretherketone)

Part Number Type	B	L (Selection)	M (Coarse)	(C)	Unit Price								
					L15	L20	L25	L30	L50	L100	L150	L200	
<b>PEKP</b>	6	15 20 25 30 50	3	6.9									
	7	20 25 30 50 100 150	4	8.1	-								
	8	20 25 30 50 100 150	5	9.2	-								
	10	25 30 50 100 150 200	6	11.5	-	-							
	13	50 100 150 200	8	15.0	-	-	-						



Ordering Example

Part Number - **L**  
**PEKP6** - 20



Alterations



Part Number - **LC**  
**PEKP6** - LC35

• Only applicable to PEKP.

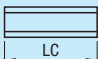
Alteration	Code	Spec.												
L Configurable	<b>LC</b>	Cuts L dimension in 1mm increment. The thread length does not change. Ordering Code LC55												
		LC Specification Range												
		<table border="1"> <thead> <tr> <th>B</th> <th>LC</th> </tr> </thead> <tbody> <tr> <td>6</td> <td>15&lt;LC&lt;50</td> </tr> <tr> <td>7</td> <td>20&lt;LC&lt;150</td> </tr> <tr> <td>8</td> <td>20&lt;LC&lt;150</td> </tr> <tr> <td>10</td> <td>25&lt;LC&lt;200</td> </tr> <tr> <td>13</td> <td>35&lt;LC&lt;200</td> </tr> </tbody> </table>	B	LC	6	15<LC<50	7	20<LC<150	8	20<LC<150	10	25<LC<200	13	35<LC<200
B	LC													
6	15<LC<50													
7	20<LC<150													
8	20<LC<150													
10	25<LC<200													
13	35<LC<200													