

Housing Units with Lubrication Unit MX

Tall Blocks / Wide Blocks

Lubrication Unit **MX** realizes maintenance free.

■ **Features:** A design that reduces linear bushing assembly steps. Suitable when the distance from the shaft center to load mounting surface needs to be fixed. Width (W dim.) is more compact than Wide Blocks.

MISUMI Original



RoHS10

Type		Linear Bushing Used	Housing		Ambient Operating Temp.
Single	Double	(☒ P.332)	Material	Surface Treatment	
LHSS-MX	LHSSW-MX	LMU-MX	Aluminum Alloy	Clear Anodize	-20~80°C

6.3 / (1.6 /)
(Housing)

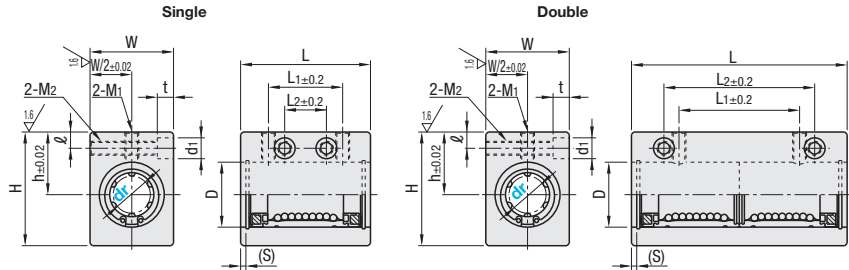

Ⓢ No need to fill with grease prior to use because the product is already filled with lithium soap-based grease in addition to the built-in lubrication unit.

Tall Block Type

Part Number		D	(S)	L		L1		L2		h	W	H	l	M1	M2	d1xt	Basic Load Rating		Allowable Static Moment (N·m)		Mass (g)		Single	Double			
Type	dr			Tolerance	Single	Double	Single	Double	Single								Double	C (Dynamic) N	Co (Static) N	Single	Double	Single	Double	Single	Double	Unit Price	Volume Discount Rate
LHSS-MX LHSSW-MX	10		19		45	74	27	36	15	50	19	26	32			8x6 (For M4 Screws)	372	588	549	1100	-	7.24	92	166			
	12	0	21	2.0	47	77					20	28	34	6	M6	M5	412	657	598	1200	-	10.9	103	185			
	16	-0.009	28	2.3	56	93	32	52	18		65	27	36	49	7	M6	M6	775	1230	1180	2350	-	19.7	237	423		
	20		32	2.8	64	106	36	58			70	31	42	54	8	M8	M8	882	1400	1370	2740	-	26.8	324	584		
	25	0	40		85	144	42	80			100	37	52	65	9	M10	M10	980	1560	1570	3140	-	43.4	672	1239		
	30	-0.010	45	2.2	92	156	44	90	22		110	40	58	71			14x10 (For M6 Screws)	1570	2490	2740	5490	-	82.8	843	1545		

Ⓢ For Precautions for Use, see ☒ P.303.

kgf=Nx0.101972

Ⓢ For orders larger than indicated quantity, please request a quotation.

Lubrication Unit **MX** realizes maintenance free.

■ **Features:** A design that reduces linear bushing assembly steps. Four mounting holes enable solid mounting with the load.

MISUMI Original



Type		Linear Bushing Used	Housing		Ambient Operating Temp.
Single	Double	(☒ P.332)	Material	Surface Treatment	
LHBB-MX	LHBBW-MX	LMU-MX	Aluminum Alloy	Clear Anodize	-20~80°C

6.3 / (1.6 /)
(Housing)

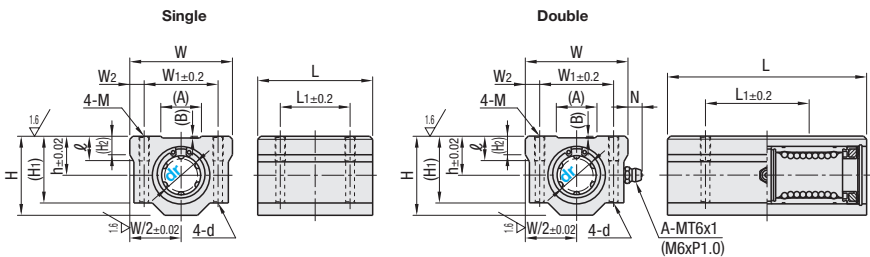

Ⓢ No need to fill with grease prior to use because the product is already filled with lithium soap-based grease in addition to the built-in lubrication unit.

Wide Block Type

Part Number		L	L1	h	H	(H1)	(H2)	W	W1	W2	M	d	l	(A)	(B)	N	Basic Load Rating		Allowable Static Moment (N·m)		Mass (g)		Single	Double				
Type	dr																Tolerance	C (Dynamic) N	Co (Static) N	Single	Double	Single	Double	Single	Double	Single	Double	
LHBB-MX LHBBW-MX	10		45	78	21	46	13	26	21	8	40	28	6			7.5	372	588	549	1100	-	7.24	114	206				
	12	0	47	81	26	50	15	28	24		42	30.5	5.75			7	412	657	598	1200	-	10.9	125	233				
	16	-0.009	56	97	34	60	19	38.5	32.5	9	50	36				7	775	1230	1180	2350	-	19.7	268	450				
	20		64	110	40	70	21	41	35	11	54	40				7	882	1400	1370	2740	-	26.8	310	647				
	25	0	85	148	50	100	26	51.5	42	12	76	54	11			7	980	1560	1570	3140	-	43.4	717	1339				
	30	-0.010	92	160	58	110	30	59.5	49	15	78	58	10			7	1570	2490	2740	5490	-	82.8	891	1665				
	35	0	102	177		120	34	68	54	18	90	70				10	53	6	1670	2650	3140	6270	-	110	1314	2448		
	40	0	114	199		140	40	78	62	20	102	80				10	61	1.5	2160	3430	4020	8040	-	147	1873	3526		
	50	-0.012	138	243		80	160	102	80	25	122	100				11	81	5.5	3820	6080	7940	15900	-	397	3821	7256		

Ⓢ For Precautions for Use, see ☒ P.303.

kgf=Nx0.101972

Ⓢ For orders larger than indicated quantity, please request a quotation.



Ordering Example

Part Number
LHSS-MX16
LHBBW-MX25

Ⓢ Various Grease Application Services are not applicable.