

# SUS-K<sub>2</sub> TYPE



There are some non-conforming products.



Fixed wheel



Plate type



Stainless steel



SUS-GUK<sub>2</sub>-150

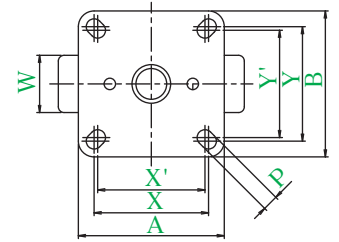
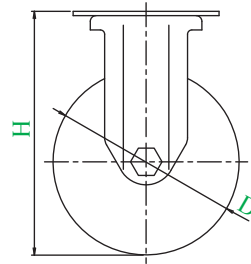

## Description of product number

**SUS - GU K<sub>2</sub> - 150**

Bracket type

Wheel type

Bracket type

Wheel diameter

Bracket = Stainless steel

Product number	Wheels									
		Wheel diameter	Wheel width	Mounting height	Mounting base	Mounting dimensions	Hole diameter	Allowance load	Wheel weight	
		D(mm)	W(mm)	H(mm)	A × B(mm)	X × Y(X' × Y') (mm)	P(mm)	daN(kgf)	(g)	
SUS-	NR K <sub>2</sub> -130	Rubber wheel with nylon wheel assembly (including B)	130	40	170	102 × 102	80 × 80 (75 × 75)	11	160(163.2)	1330
		Nylon wheel (including B)							150(153.0)	1140
		Urethane wheel with nylon wheel assembly (including B)							160(163.2)	1210
	NR K <sub>2</sub> -150	Rubber wheel with nylon wheel assembly (including B)	150	40	190	102 × 102	80 × 80 (75 × 75)	11	180(183.6)	1290
		Nylon wheel (including B)							160(163.2)	1210
		Urethane wheel with nylon wheel assembly (including B)							180(183.6)	1270

### Wheel in use

Refer to P162 for detailed specifications.



**NR**  
Rubber wheel with nylon wheel assembly (including B)



**N**  
Nylon wheel (including B)



**GU**  
Urethane wheel with nylon wheel assembly (including B)

J

PM

J<sub>2</sub>

RJ<sub>2</sub>

SJ

S

E

G

L

SA

H

CAL  
-H

M

PL

Silence

**SUS**  
-J<sub>2</sub>

SUS

-SJ

SUS

-S

SUS

-E

SUS

-H

P

SKY

Equipped with adjuster foot

Special

Easy lock

Wheels