

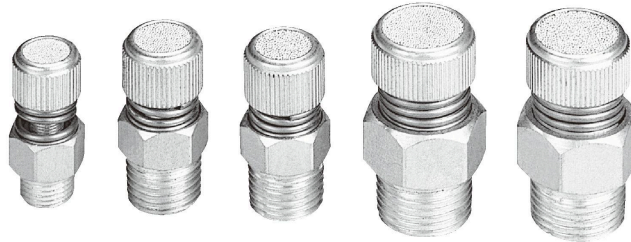

SLBR series - Slinger (Brass)

Specification and External dimension

CHELIC PNEUMATIC



CJ-M
Float joint

M□V
Manually operated valve

SA□
Shock absorber

SHR
Hydraulic regulator

SL□
Silencer

P□S
Rod end

Specification

| Item | Model | SLBR - 01 | SLBR - 02 | SLBR - 03 | SLBR - 04 |
|------------------------------|---------------------------|--|-----------|-----------|-----------|
| Fluid | | Air | | | |
| Range of service pressure | kgf/cm ² (kpa) | 0 ~ 9 (900) | | | |
| Ensure withstanding pressure | kgf/cm ² (kpa) | 13 (1300) | | | |
| Range of service temperature | °C | 5 ~ 60 | | | |
| Material | Body | Brass | | | |
| | Filter element | Brass (The thick of air pass through position 60μm) | | | |
| Connection port | Rc (PT) | 1/8" | 1/4" | 3/8" | 1/2" |
| Weight | g | 55 | | | 60 |

External dimension

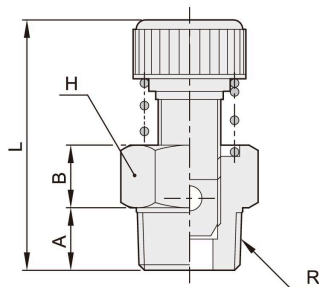

| Model | Code | Connection port Rc (PT) | A | B | L | | Cross flat distance H |
|-----------|------|----------------------------|----|----|-----|-----|--------------------------|
| | | | | | MIN | MAX | |
| SLBR - 01 | | 1/8" | 6 | 8 | 28 | 33 | 12 |
| SLBR - 02 | | 1/4" | 9 | 12 | 30 | 35 | 16 |
| SLBR - 03 | | 3/8" | 10 | 14 | 34 | 40 | 18 |
| SLBR - 04 | | 1/2" | 10 | 20 | 36 | 42 | 22 |