

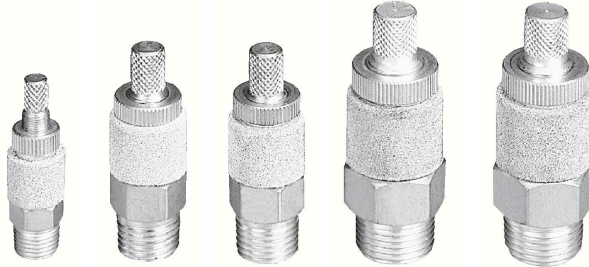

SLR series - Slinger (Brass)

Specification and External dimension



Specification

Item	Model	SLR - 01	SLR - 02	SLR - 03
Fluid		Air		
Range of service pressure	kgf/cm ² (kpa)	0 ~ 9 (900)		
Ensure withstanding pressure	kgf/cm ² (kpa)	13 (1300)		
Range of service temperature	°C	5 ~ 60		
Material	Body	Brass		
	Filter element	Brass (The thick of air pass through position 60μm)		
Connection port	Rc (PT)	1/8"	1/4"	3/8"
Weight	g	55		

External dimension

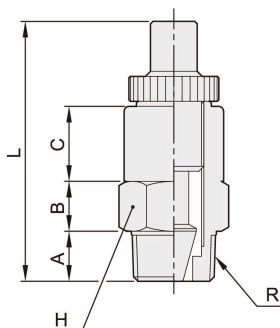

Model	Code	Connection port Rc (PT)	A	B	C	L	Cross flat distance H
SLR - 01		1/8"	7	7	10	38.2	9.9
SLR - 02		1/4"	9.7	7	12	44.6	14
SLR - 03		3/8"	10	10	15	52.6	19