



SL series - Slinger (Brass)

Specification and External dimension

CHELIC PNEUMATIC



规格表

Item	Model	SL - M5	SL - 01	SL - 02	SL - 03	SL - 04	SL - 06
Fluid		Air					
Range of service pressure	kgf/cm ² (kpa)	0 ~ 9 (900)					
Ensure withstanding pressure	kgf/cm ² (kpa)	13 (1300)					
Range of service temperature	°C	5 ~ 60					
Material	Body	Brass					
	Filter element	Brass (The thick of air pass through position 60μm)					
Connection port	Rc (PT)	M5 x 0.8p	1/8"	1/4"	3/8"	1/2"	3/4"
Weight	g	3	55			60	68

External dimension

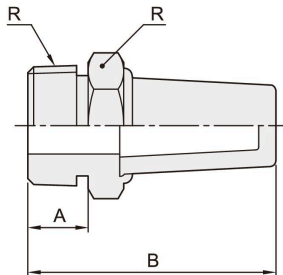

Model	Code	Connection port R Rc (PT)	A	B	Cross flat distance H
SL - M5		M5	5	18	8
SL - 01		1/8"	6	23	12
SL - 02		1/4"	8	29	16
SL - 03		3/8"	9	35	18
SL - 04		1/2"	10	43	22
SL - 06		3/4"	10	50	30