

球面軸承 / SPHERICAL BEARING

PB, PBN, PB_T Series

PB_T, PBN系列接單生產 (PB_T, PBN Series MADE BY ORDER)

材質

- 外框: PB, PB_T系列 - 中碳鋼S45C。
PBN系列 - 中碳鋼S45C, 表面磷酸錳皮膜處理。
- 鋼珠: 鉻鉬軸承鋼SUJ-2, 熱處理 HRC 56 \pm 2, 鍍硬鉻。
- 襯墊: PB 系列 - 合金銅。
PB_T 系列 - 鐵氟龍銅網 (PTFE)。
PBN 系列 - 特殊耐磨尼龍複合材料。

MATERIALS

- RACE: PB, PB_T Series - Medium Carbon Steel S45C
PBN Series - Medium Carbon Steel S45C, Phosphatizing Treated
- BALL: Bearing Steel SUJ-2, Heat Treated HRC 56 \pm 2, Hard Chrome Plated
- LINER: PB Series - Copper Alloy
PB_T Series - PTFE
PBN Series - Special Reinforce Nylon Material

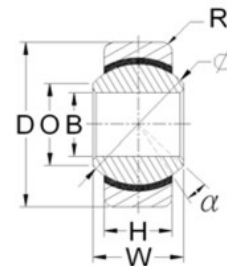
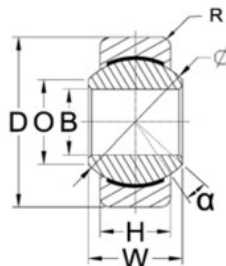
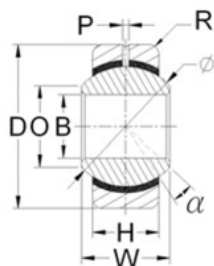

■ 間隙 (Unit: mm)
徑向間隙值: 小於0.035
軸向間隙值: 小於0.1

■ Clearance (Unit: mm)
Radial Clearance: 0.035 or less
Axial Clearance: 0.1 or less

■ 間隙 (mm)
徑向間隙值: 小於0.035
軸向間隙值: 小於0.05

■ Clearance (Unit: mm)
Radial Clearance: 0.035 or less
Axial Clearance: 0.05 or less

公制尺寸 / DIMENSIONS IN METRIC mm

型號 Model No.	B	W	D	O	H	P	R	旋角 α	球徑 Ball Dia. \varnothing	徑向荷重 Radial S. load (kgf)	重量 Weight (g)
PB 4T	4	7	13.0	7.0	4.5	-	0.5	13.00	10.32	550	5
PB 5 PB 5T PBN 5	5	8	16.0	7.7	6.0	0.8 -	0.5	13.00	11.11	790	9
PB 6 PB 6T PBN 6	6	9	18.0	8.9	6.7	0.8 -	1.0	13	12.70	990	14
PB 8 PB 8T PBN 8	8	12	22.0	10.4	9.0	1 -	1.0	13	15.88	1630	24
PB 10 PB 10T PBN 10	10	14	26.0	12.9	10.5	1 -	1.5	13	19.05	2340	39
PB 12 PB 12T PBN 12	12	16	30.0	15.4	12.0	1 -	1.5	13	22.23	3160	58
PB 14 PB 14T	14	19	34.0	16.8	14.0	1.2 -	2.0	15	25.40	4080	86
PB 16 PB 16T PBN 16	16	21	38.0	19.3	15.0	1.2 -	2.0	15	28.58	5090	115
PB 18 PB 18T	18	23	42.0	21.8	17.0	1.5 -	2.0	15	31.75	6220	160
PB 20 PB 20T PBN 20	20	25	46.0	24.3	18.0	1.5 -	3.0	15	34.93	7440	200
PB 22 PB 22T	22	28	50.0	25.8	20.0	1.5 -	3.0	15	38.10	8970	260
PB 25 PB 25T	25	31	56.0	29.6	22.0	1.5 -	3.0	15	42.85	11210	360

*註: PB_T及PBN 系列為接單生產。
*NOTE: PB_T & PBN Series are made by order.