

## Metal Caster

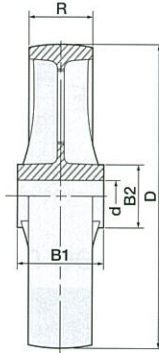

### FA Metal (non-bearing)

unit:mm

| Wheel diameter | Type  | Load capacity | Wheel width | Hub length | Axle hole diameter | Boss diameter |
|----------------|-------|---------------|-------------|------------|--------------------|---------------|
| 75             | 75FA  | 140 kg        | 32          | 37         | 10                 | 20            |
| 100            | 100FA | 190 kg        | 35          | 44         | 12                 | 24            |
| 127            | 125FA | 280 kg        | 38          | 49         | 17                 | 32            |
| 150            | 150FA | 350 kg        | 40          | 53         | 20                 | 35            |
| 180            | 180FA | 430 kg        | 42          | 54         | 20                 | 35            |
| 200            | 200FA | 490 kg        | 44          | 57         | 20                 | 38            |
| 250            | 250FA | 650 kg        | 48          | 63         | 25                 | 43            |

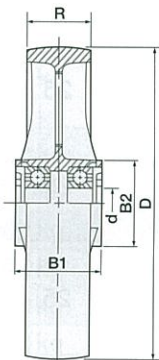

### FB Metal (with bearing)

unit:mm

| Wheel diameter | Type  | Load capacity | Wheel width | Hub length | Axle hole diameter | Boss diameter | Bearing No |
|----------------|-------|---------------|-------------|------------|--------------------|---------------|------------|
| 75             | 75FB  | 140 kg        | 32          | 37         | 10                 | 42            | CB1030     |
| 100            | 100FB | 190 kg        | 35          | 44         | 12                 | 42            | CB1232     |
| 127            | 125FB | 280 kg        | 38          | 49         | 17                 | 50            | #6203      |
| 150            | 150FB | 350 kg        | 40          | 53         | 20                 | 58            | #6204      |
| 180            | 180FB | 430 kg        | 42          | 54         | 20                 | 58            | #6204      |
| 200            | 200FB | 490 kg        | 44          | 57         | 20                 | 59            | #6204      |
| 250            | 250FB | 650 kg        | 48          | 63         | 25                 | 74            | #6305      |
| 300            | 300FB | 830 kg        | 50          | 67         | 25                 | 74            | #6305      |

## Monomer Casting Nylon Caster

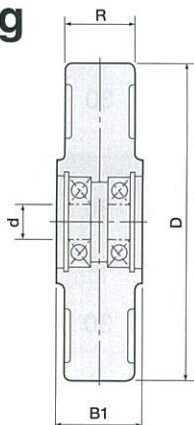

### MCB MC Nylon (with bearing)

unit:mm

| Wheel diameter | Type   | Load capacity | Wheel width | Hub length | Axle hole diameter | Bearing No |
|----------------|--------|---------------|-------------|------------|--------------------|------------|
| 75             | 75MCB  | 300kg         | 32          | 32         | 10                 | 6200Z      |
| 100            | 100MCB | 450kg         | 35          | 40         | 12                 | 6201Z      |
| 125            | 125MCB | 750kg         | 38          | 45         | 17                 | 6203Z      |
| 150            | 150MCB | 1000kg        | 40          | 49         | 20                 | 6204Z      |
| 180            | 180MCB | 1200kg        | 42          | 50         | 20                 | 6204Z      |
| 200            | 200MCB | 1300kg        | 44          | 53         | 20                 | 6204Z      |
| 250            | 250MCB | 2000kg        | 48          | 59         | 25                 | 6205Z      |
| 300            | 300MCB | 2700kg        | 50          | 63         | 25                 | 6205Z      |

※We have non-bearing wheels. (MCA)

※The above is the load capacity of the wheel.

## Urethane Caster

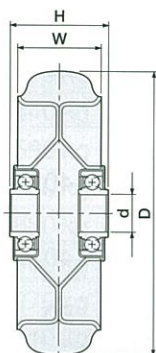

### ULSB Urethane Caster (with bearing)

unit:mm

| Wheel diameter | Type | Load capacity | Wheel width | Hub length | Axle hole diameter | Wheel diameter (without rubber) | Rubber wide | Bearing No |
|----------------|------|---------------|-------------|------------|--------------------|---------------------------------|-------------|------------|
| 75             | 75   | 100 kg        | 30          | 37         | 10                 | 59                              | 8           | CB1030     |
| 100            | 100  | 150 kg        | 33          | 44         | 12                 | 80                              | 10          | CB1232     |
| 127            | 125  | 200 kg        | 36          | 49         | 17                 | 107                             | 10          | CB1740     |
| 150            | 150  | 250 kg        | 38          | 53         | 20                 | 130                             | 10          | CB2047     |
| 200            | 200  | 350 kg        | 42          | 57         | 20                 | 180                             | 10          | CB2047     |