

■ Insert

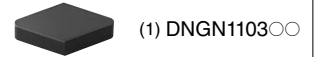

(1) DNGN110300

■ Holder

■ Parts

Cat. No.	Stock		Dimensions (mm)						Applicable Insert	Clamp	Chip Breaker	Double Screw	Shim	Shim Pin	Wrench	
	R	L	h	b	L ₁	f	h ₁	L ₂								e
CDJN R/L2525-32	●		25	25	150	32	25	30	7	DNGN110300	CCM8UL	CBD1103	WB8-22T	SDN1103	SPP3	LT27

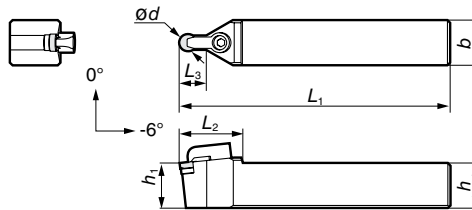
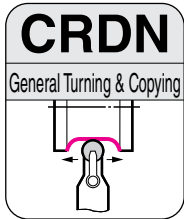

■ Insert



(1) RNGN090300
(2) RNGN120300
(3) RNGN120400

■ Holder

■ Parts

Cat. No.	Stock		Dimensions (mm)							Applicable Insert	Clamp	Double Screw	Shim	Shim Pin	Wrench
	R	L	∅d	h	b	L ₁	h ₁	L ₂	L ₃						
CRDN N2525-32	●		9.525	25	25	150	25	35	15	RNGN090300	CCM8-LONG	WB8-22T	SRND32	SPP3	LT27
N2525-42	●		12.7	25	25	150	25	35	20	RNGN120300			SRND42		
N2525-43	●		12.7	25	25	150	25	35	20	RNGN120400			SRND42		

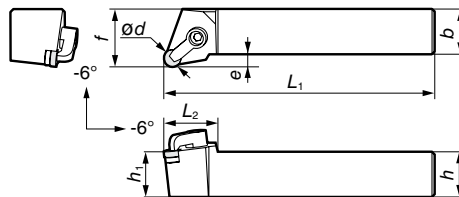
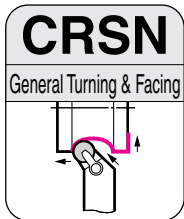

■ Insert



(1) RNGN090300
(2) RNGN120300
(3) RNGN120400

■ Holder

■ Parts

Cat. No.	Stock		Dimensions (mm)									Applicable Insert	Clamp	Double Screw	Shim	Shim Pin	Wrench
	R	L	∅d	h	b	L ₁	f	h ₁	L ₂	e							
CRSN R/L2525-32	●		9.525	25	25	150	32	25	30	7	RNGN090300	CCM8-LONG	WB8-22T	SRND32	SPP3	LT27	
R/L2525-42	●		12.7	25	25	150	32	25	30	7	RNGN120300			SRND42			
R/L2525-43	●		12.7	25	25	150	32	25	30	7	RNGN120400			SRND42			

Dimple Lock Type

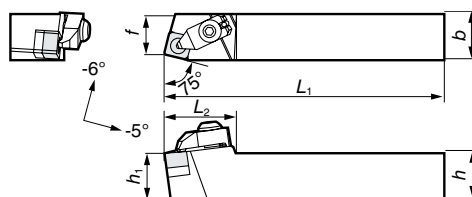
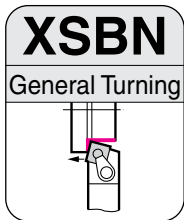

■ Insert



(1) SNGX120400

■ Holder

■ Parts

Cat. No.	Stock		Dimensions (mm)						Applicable Insert	Clamp	Bolt	Shim	Shim Pin	Spring	Wrench	
	R	L	h	b	L ₁	f	h ₁	L ₂								
XSBN R/L2525-43	●		25	25	150	21.5	25	38		SNGX120400	DSLX8	BH0825	SSND433	SPP3	GSP10	LH050

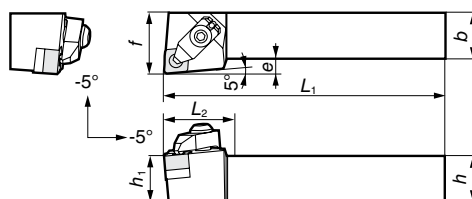

■ Insert



(1) CNGX120400

■ Holder

■ Parts

Cat. No.	Stock		Dimensions (mm)						Applicable Insert	Clamp	Bolt	Shim	Shim Pin	Spring	Wrench	
	R	L	h	b	L ₁	f	h ₁	L ₂								e
XCLN R/L2525-43	●		25	25	150	32	25	33	7	CNGX120400	DSLX8	BH0825	SCND433	SPP3	GSP10	LH050