

LATCH SERIES WITH SAFETY LOCK

**PATENT
PENDING**

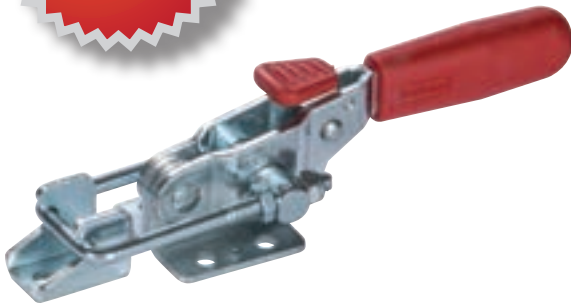

NEW

DOUBLE ROD SERIES WITH SAFETY LOCK (LIGHT PERFORMANCE)

The sizes of this series are also produced in **AISI 316 stainless steel** and are shown below in red.

Material:

Galvanized steel or **AISI 316 stainless steel**

Riveted pivots and rod:

Galvanized steel or **AISI 316 stainless steel**

Swinging pivot:

Galvanized steel or **AISI 316 stainless steel**

Handles:

Red polyurethane resistant to oils, grease and other chemical agents.

Performance:

The tool comes with a double rod, bracket and nuts

Features and applications:

The main feature of this series is the special anti-release lever with the purpose of avoiding any accidental openings caused by vibrations.

The tools of this series ensure a perfect closing of lids. The support base is perpendicular to the force line of action. In the closed position, the control lever is parallel to the support base. A special grease is placed between two contacting surfaces during assembly.

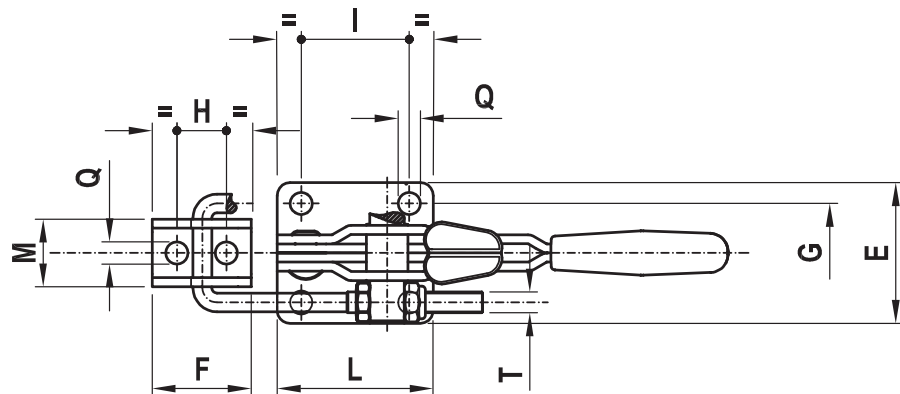
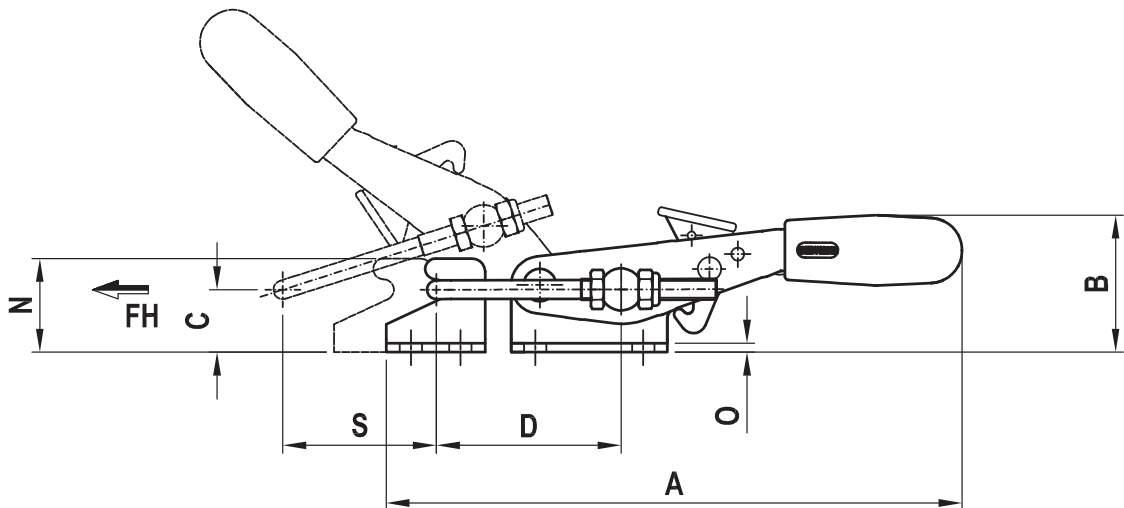
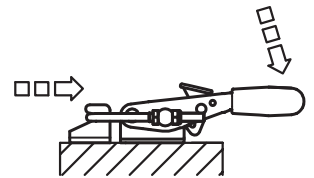

Code	Description	Stainless steel Code	Stainless steel	A	B	C	D	E	F	G	H	I	L	M	N	O	Q	S	T	Fh (Dan)	gr.	gr. inox
AL780	160/T6	AS600	160/T16	101	31	12	35÷44	28	20	19	10	16	26	14	18	2	4,3	25	M4	160	92	95
AL785	320/T6	AS605	320/T16	169	45	16	54÷63	44	28	32	14,3	19	40	22	25	3	6,5	44	M6	320	307	331
AL790	700/T6	AS610	700/T16	221	56	24	70÷90	54	38	38	19	41,5	60	26	36	3,5	8,5	58	M8	750	627	644