

PSL-D Models

Specifications

| Model | Rated torque [N·m] | Rated thrust [N] | Shaft contact pressure [N/mm ²] | Hub contact pressure [N/mm ²] | Tightening torque [N·m] | Moment of inertia [kg·m ²] | Mass [kg] |
|----------|--------------------|------------------|---|---|-------------------------|--|-----------|
| PSL-D-6 | 6 | 2100 | 150 | 60 | 1 | 0.48×10^{-6} | 0.012 |
| PSL-D-7 | 8 | 2100 | 140 | 60 | 1 | 0.52×10^{-6} | 0.013 |
| PSL-D-8 | 10 | 2600 | 110 | 50 | 1 | 0.77×10^{-6} | 0.015 |
| PSL-D-9 | 15 | 3200 | 130 | 60 | 1 | 1.1×10^{-6} | 0.020 |
| PSL-D-10 | 16 | 3200 | 110 | 60 | 1 | 1.2×10^{-6} | 0.019 |
| PSL-D-11 | 17 | 3200 | 100 | 50 | 1 | 1.8×10^{-6} | 0.024 |
| PSL-D-12 | 19 | 3200 | 100 | 50 | 1 | 1.7×10^{-6} | 0.022 |
| PSL-D-14 | 34 | 4800 | 100 | 50 | 2 | 4.3×10^{-6} | 0.039 |
| PSL-D-15 | 36 | 4800 | 90 | 50 | 2 | 5.7×10^{-6} | 0.044 |
| PSL-D-16 | 67 | 8400 | 130 | 60 | 4 | 10×10^{-6} | 0.068 |
| PSL-D-17 | 70 | 8400 | 120 | 60 | 4 | 18×10^{-6} | 0.093 |
| PSL-D-18 | 75 | 8400 | 110 | 60 | 4 | 17×10^{-6} | 0.090 |
| PSL-D-19 | 80 | 8400 | 110 | 60 | 4 | 16×10^{-6} | 0.085 |
| PSL-D-20 | 140 | 13600 | 150 | 80 | 8 | 24×10^{-6} | 0.120 |
| PSL-D-22 | 150 | 13600 | 140 | 80 | 8 | 29×10^{-6} | 0.130 |
| PSL-D-24 | 230 | 19300 | 150 | 80 | 14 | 70×10^{-6} | 0.220 |
| PSL-D-25 | 240 | 19300 | 140 | 80 | 14 | 69×10^{-6} | 0.210 |
| PSL-D-28 | 400 | 28900 | 190 | 110 | 14 | 86×10^{-6} | 0.240 |
| PSL-D-30 | 430 | 28900 | 180 | 100 | 14 | 128×10^{-6} | 0.270 |
| PSL-D-32 | 460 | 28900 | 170 | 100 | 14 | 123×10^{-6} | 0.260 |
| PSL-D-35 | 670 | 38600 | 160 | 90 | 14 | 215×10^{-6} | 0.370 |
| PSL-D-38 | 730 | 38600 | 150 | 90 | 14 | 298×10^{-6} | 0.420 |
| PSL-D-40 | 770 | 38600 | 140 | 90 | 14 | 286×10^{-6} | 0.410 |
| PSL-D-42 | 1110 | 52700 | 150 | 80 | 34 | 682×10^{-6} | 0.700 |
| PSL-D-45 | 1200 | 52700 | 140 | 80 | 34 | 609×10^{-6} | 0.630 |
| PSL-D-48 | 1690 | 70300 | 190 | 110 | 34 | 769×10^{-6} | 0.730 |
| PSL-D-50 | 1760 | 70300 | 180 | 110 | 34 | 742×10^{-6} | 0.710 |

* The rated torque values are those when the thrust is zero and the rated thrust values are those when the torque is zero.

Dimensions

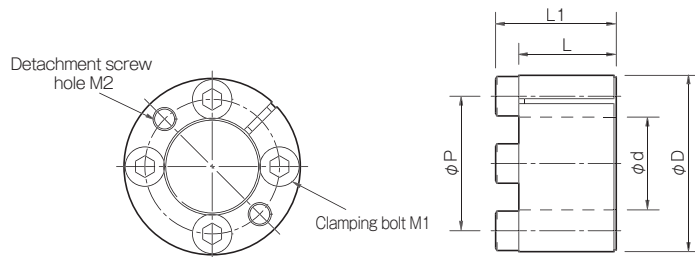

How to Place an Order

PSL-D-
Size
Old model ETP - D -

Unit [mm]

| Model | d | D | P | L | L1 | M1 | M2 |
|----------|----|----|------|----|------|-------------|--------|
| PSL-D-6 | 6 | 16 | 11 | 11 | 13.5 | 3-M2.5 × 10 | 2-M2.5 |
| PSL-D-7 | 7 | 17 | 12 | 11 | 13.5 | 3-M2.5 × 10 | 2-M2.5 |
| PSL-D-8 | 8 | 18 | 13 | 11 | 13.5 | 3-M2.5 × 10 | 2-M2.5 |
| PSL-D-9 | 9 | 20 | 15 | 13 | 15.5 | 4-M2.5 × 12 | 2-M2.5 |
| PSL-D-10 | 10 | 20 | 15 | 13 | 15.5 | 4-M2.5 × 12 | 2-M2.5 |
| PSL-D-11 | 11 | 22 | 17 | 13 | 15.5 | 4-M2.5 × 12 | 2-M2.5 |
| PSL-D-12 | 12 | 22 | 17 | 13 | 15.5 | 4-M2.5 × 12 | 2-M2.5 |
| PSL-D-14 | 14 | 26 | 20 | 17 | 20 | 4-M3 × 16 | 2-M3 |
| PSL-D-15 | 15 | 28 | 21.5 | 17 | 20 | 4-M3 × 16 | 2-M3 |
| PSL-D-16 | 16 | 32 | 24 | 17 | 21 | 4-M4 × 16 | 2-M4 |
| PSL-D-17 | 17 | 35 | 27 | 21 | 25 | 4-M4 × 20 | 2-M4 |
| PSL-D-18 | 18 | 35 | 27 | 21 | 25 | 4-M4 × 20 | 2-M4 |
| PSL-D-19 | 19 | 35 | 27 | 21 | 25 | 4-M4 × 20 | 2-M4 |
| PSL-D-20 | 20 | 38 | 29 | 21 | 26 | 4-M5 × 20 | 2-M5 |
| PSL-D-22 | 22 | 40 | 31 | 21 | 26 | 4-M5 × 20 | 2-M5 |
| PSL-D-24 | 24 | 47 | 36 | 26 | 32 | 4-M6 × 25 | 2-M6 |
| PSL-D-25 | 25 | 47 | 36 | 26 | 32 | 4-M6 × 25 | 2-M6 |
| PSL-D-28 | 28 | 50 | 39 | 26 | 32 | 6-M6 × 25 | 2-M6 |
| PSL-D-30 | 30 | 55 | 43.5 | 26 | 32 | 6-M6 × 25 | 2-M6 |
| PSL-D-32 | 32 | 55 | 43.5 | 26 | 32 | 6-M6 × 25 | 2-M6 |
| PSL-D-35 | 35 | 60 | 47.5 | 31 | 37 | 8-M6 × 30 | 2-M6 |
| PSL-D-38 | 38 | 65 | 52.5 | 31 | 37 | 8-M6 × 30 | 2-M6 |
| PSL-D-40 | 40 | 65 | 52.5 | 31 | 37 | 8-M6 × 30 | 2-M6 |
| PSL-D-42 | 42 | 75 | 60 | 36 | 44 | 6-M8 × 35 | 2-M8 |
| PSL-D-45 | 45 | 75 | 60 | 36 | 44 | 6-M8 × 35 | 2-M8 |
| PSL-D-48 | 48 | 80 | 65 | 36 | 44 | 8-M8 × 35 | 2-M8 |
| PSL-D-50 | 50 | 80 | 65 | 36 | 44 | 8-M8 × 35 | 2-M8 |

* L and L1 are dimensions before the POSI-LOCK is mounted.

* The nominal diameter of each bolt and tap is equal to the quantity minus the nominal diameter of the screw threads times the nominal length.