

Order No. Example

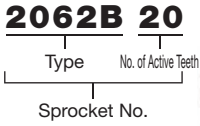

Ground Specification Welded Specification

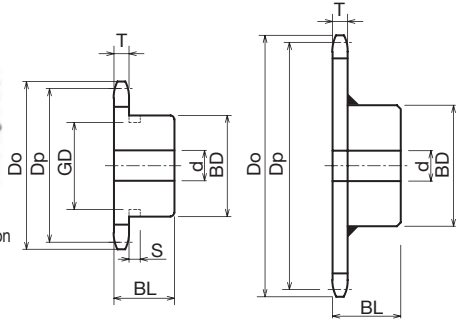

Ground Specification

Welded Specification

- Chain No.C2062H
- Chain Pitch (P)38.10mm
- Roller Link Inner Width (W)12.70mm
- Roller Outside Diameter (Dr)22.23mm
- Tooth Width (T)11.7 mm

Type	Action No. of Teeth	Outer Diameter Do	Pitch Diameter Dp	Shaft Hole Diameter d			Boss Diameter BD	Boss Length BL	Shape	Material	Weight kg	¥	Semi-F ¥
				Prepared Holes	Minimum	Maximum							
2062B	7	102	87.81	18	19	40	★60	40	Ground Specification	Structural Steel	0.97		
	8	115	99.56	18	19	50	★75	40			1.44		
	9	128	111.40	18	19	50	80	40			1.80		
	10	140	123.29	18	19	55	80	45			2.50		
	11	153	135.23	18	19	55	83	45			2.60		
	12	165	147.21	18	19	55	83	45			2.80		
	13	177	159.20	25	26	55	83	45	Welded Specification	Common Steel	3.10		
	14	190	171.22	25	26	55	83	45			3.60		
	15	202	183.25	25	26	55	83	45			3.90		
	16	214	195.29	25	26	55	83	45			4.20		
	17	227	207.35	25	26	63	93	45			4.60		
	18	239	219.41	25	26	63	93	45			5.00		
	19	251	231.48	25	26	63	93	45			5.50		
	20	263	243.55	25	26	63	93	45			6.00		
	21	276	255.63	25	26	63	93	45			5.89		
	22	288	267.72	26	27	63	93	45			6.34		
	24	312	291.90	26	27	63	93	45			7.28		
	25	324	303.99	26	27	63	93	45			7.77		
	26	337	316.09	26	27	63	93	45			8.77		
	28	361	340.29	26	27	63	93	45			9.90		
	30	385	364.49	26	27	63	93	45			11.20		

Sprocket No. and Quantity

Guide

* Since we also manufacture sizes other than those in the catalog, and machine shaft holes/keys/taps, etc., depending on your request, please contact our company's sales office for details.

Same-day shipping

! Sprockets with a ★ symbol for BD have a channel in the boss exterior.

No. of Teeth	S	GD
7		56
8	10	68

* Please refer to P24 to P33 for the Semi-F Series <Complete Product> order method.