

SUS2050B



SUS Standard Stainless Steel Double Pitch Sprocket for S Rollers B-type

Order No. Example

SUS 2050B 9 1/2

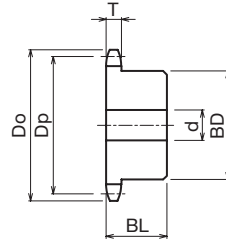
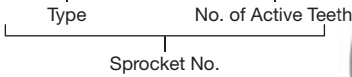

- Chain No.C2050
- Chain Pitch (P)31.75mm
- Roller Link Inner Width (W) 9.53mm
- Roller Outside Diameter (Dr)10.16mm
- Tooth Width (T) 8.7 mm

m Stainless Steel **GB** 304

Type	Action No. of Teeth	Actual No. of Teeth	Outer Diameter Do	Pitch Diameter Dp	Shaft Hole Diameter d			Boss Diameter BD	Boss Length BL	Shape	Weight kg	¥	Semi-F ¥
					Prepared Holes	Minimum	Maximum						
SUS 2050B	9 1/2	19	105	97.78	14	15	48	73	28	Ground Specification	1.10		
	10 1/2	21	115	107.72	14	15	48	73	28		1.62		
	11 1/2	23	125	117.68	16	17	48	73	28		1.74		
	12 1/2	25	135	127.67	16	17	48	73	28		1.87		



Order Method: Sprocket No. and Quantity



Postage: Same-day shipping



Guide: * Since we also manufacture sizes other than those in the catalog, and machine shaft holes/keys/taps, etc., depending on your request, please contact our company's sales office for details.

* Please refer to P24 to P33 for the Semi-F Series <Complete Product> order method.