

K80B



K Sprocket Former B-type

Order No. Example

K 80B 15

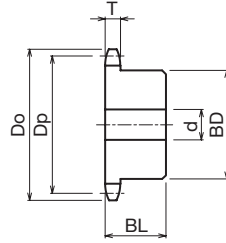
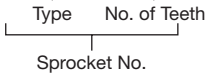

- ChainNo.80
- Chain Pitch(P)25.4 mm
- Roller Link Inner Width(W)15.88mm
- Roller Outside Diameter(Dr)15.88mm
- Tooth Width(T)14.6 mm

- m Carbon Structural Steel
- h High-frequency Hardened Teeth

Type	No. of Teeth	Outer Diameter Do	Pitch Diameter Dp	Shaft Hole Diameter d			Boss Diameter BD	Boss Length BL	Shape	Weight kg	¥	Semi-F ¥
				Prepared Hole Product	Minimum	Maximum						
K 80B	10	93	82.19	15	16	32	55	50	Ground Specification	1.50		
	11	102	90.16	15	16	38	60	50		1.70		
	12	110	98.14	15	16	46	69	50		1.90		
	13	118	106.14	16	17	51	77	50		2.10		
	14	127	114.15	16	17	55	80	50		2.40		
	15	135	122.17	20	21	55	80	50		2.60		
	16	143	130.20	20	21	55	80	50		3.00		
	17	151	138.23	20	21	60	90	50		3.30		
	18	159	146.27	20	21	60	90	50		3.50		
	19	167	154.32	20	21	60	90	50		3.70		
	20	176	162.37	20	21	60	90	50		4.30		
21	184	170.42	20	21	60	90	50	4.40				

* Please refer to P24 to P33 for the Semi-F Series <Complete Product> order method.



Order Method

Sprocket No. and Quantity



Postage

Same-day shipping



Guide

* Since we also manufacture sizes other than those in the catalog, and machine shaft holes/keys/taps, etc., depending on your request, please contact our company's sales office for details.