

Order No. Example

K60B 15

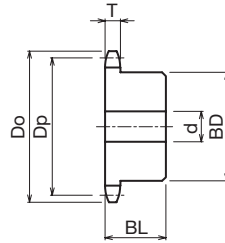
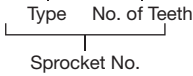

- Chain No.60
- Chain Pitch (P)19.05mm
- Roller Link Inner Width (W)12.70mm
- Roller Outside Diameter (Dr)11.91mm
- Tooth Width (T)11.7 mm

- m Carbon Structural Steel
- h High-frequency Hardened Teeth

Type	No. of Teeth	Outer Diameter Do	Pitch Diameter Dp	Shaft Hole Diameter d			Boss Diameter BD	Boss Length BL	Shape	Weight kg	¥	Semi-F ¥
				Prepared Hole Product	Minimum	Maximum						
K60B	10	70	61.65	13	14	22	39	40	Ground Specification	0.60		
	11	76	67.62	13	14	28	45	40		0.70		
	12	83	73.60	13	14	32	51	40		0.80		
	13	89	79.60	13	14	35	56	40		0.90		
	14	95	85.61	16	17	35	56	40		1.00		
	15	101	91.62	16	17	35	56	40		1.10		
	16	107	97.65	16	17	35	56	40		1.20		
	17	113	103.67	16	17	46	70	40		1.60		
	18	119	109.71	16	17	46	70	40		1.90		
	19	126	115.74	16	17	46	70	40		2.10		
	20	132	121.78	16	17	55	80	45		2.40		
	21	138	127.82	16	17	55	80	45		2.50		
	22	144	133.86	16	17	55	80	45		2.60		
	23	150	139.90	16	17	55	80	45		2.80		
	24	156	145.95	18	19	55	80	45		3.00		
	25	162	151.99	18	19	55	80	45		3.20		
	26	168	158.04	18	19	55	80	45		3.30		
	27	174	164.09	18	19	55	80	45		3.50		
	28	180	170.14	18	19	57	85	50		3.50		
	29	187	176.20	18	19	57	85	50		3.60		
	30	193	182.25	18	19	57	85	50		4.00		



Sprocket No. and Quantity



* Since we also manufacture sizes other than those in the catalog, and machine shaft holes/keys/taps, etc., depending on your request, please contact our company's sales office for details.



Same-day shipping

Postage

* Please refer to P24 to P33 for the Semi-F Series <Complete Product> order method.