

# HG50A

## ● Order No. Example

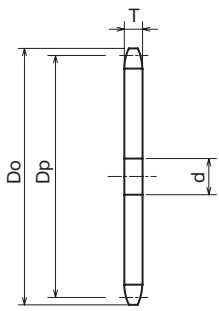
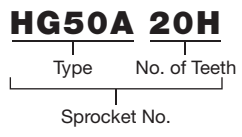

- Chain .....No.50
- Chain Pitch .....(P)15.875mm
- Roller Link Inner Width .....(W) 9.53 mm
- Roller Outside Diameter .....(Dr)10.16 mm
- Tooth Width .....(T) 8.7 mm

**m** Carbon Structural Steel  
**h** High-frequency Hardened Teeth

Type	No. of Teeth	Outer Diameter Do	Pitch Diameter Dp	Shaft Hole Diameter d		Weight kg	¥	Semi-F ¥
				Prepared Hole Product	Minimum			
HG 50A	10H	58	51.37	10	11	0.14		
	11H	64	56.35	12	13	0.17		
	12H	69	61.34	12	13	0.20		
	13H	74	66.34	12	13	0.23		
	14H	79	71.34	12	13	0.27		
	15H	84	76.35	12	13	0.30		
	16H	89	81.37	14	15	0.35		
	17H	94	86.39	14	15	0.40		
	18H	100	91.42	14	15	0.45		
	19H	105	96.45	14	15	0.48		
	20H	110	101.48	14	15	0.50		
	21H	115	106.51	14	15	0.60		
	22H	120	111.55	16	17	0.66		
	23H	125	116.58	16	17	0.72		
	24H	130	121.62	16	17	0.78		
	25H	135	126.66	16	17	0.85		
	26H	140	131.70	16	17	0.90		
	27H	145	136.74	16	17	1.00		
	28H	150	141.79	16	17	1.05		
	29H	155	146.83	16	17	1.12		