

K410B



Standard Sprocket B-type

Order No. Example

K410B 15

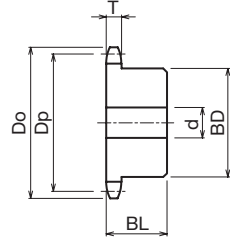
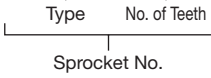

- Chain No.410
- Chain Pitch (P)12.70mm
- Roller Link Inner Width (W) 3.40mm
- Roller Outside Diameter (Dr) 7.75mm
- Tooth Width (T) 2.8 mm

m Carbon Structural Steel

| Type | No. of Teeth | Outer Diameter Do | Pitch Diameter Dp | Shaft Hole Diameter d | | | Boss Diameter BD | Boss Length BL | Shape | Weight kg | ¥ | Semi-F |
|-------|--------------|----------------------|----------------------|-----------------------|---------|---------|---------------------|-------------------|----------------------|--------------|---|--------|
| | | | | Prepared Hole Product | Minimum | Maximum | | | | | | ¥ |
| K410B | 10 | 47 | 41.10 | 9 | 10 | 16 | 28 | 20 | Ground Specification | 0.14 | | |
| | 11 | 51 | 45.08 | 10 | 11 | 16 | 30 | 20 | | 0.19 | | |
| | 12 | 55 | 49.07 | 10 | 11 | 18 | 34 | 20 | | 0.22 | | |
| | 13 | 59 | 53.07 | 12 | 13 | 20 | 38 | 20 | | 0.23 | | |
| | 14 | 63 | 57.07 | 12 | 13 | 25 | 42 | 20 | | 0.28 | | |
| | 15 | 67 | 61.08 | 12 | 13 | 28 | 46 | 20 | | 0.34 | | |
| | 16 | 71 | 65.10 | 13 | 14 | 30 | 50 | 20 | | 0.40 | | |
| | 17 | 76 | 69.12 | 13 | 14 | 32 | 54 | 22 | | 0.46 | | |
| | 18 | 80 | 73.14 | 13 | 14 | 35 | 57 | 22 | | 0.51 | | |
| | 19 | 84 | 77.16 | 13 | 14 | 40 | 62 | 22 | | 0.59 | | |
| | 20 | 88 | 81.18 | 14 | 15 | 45 | 67 | 25 | | 0.76 | | |
| | 21 | 92 | 85.21 | 14 | 15 | 48 | 71 | 25 | | 0.85 | | |
| | 22 | 96 | 89.24 | 14 | 15 | 51 | 75 | 25 | | 0.95 | | |
| | 23 | 100 | 93.27 | 14 | 15 | 51 | 77 | 25 | | 1.00 | | |
| | 24 | 104 | 97.30 | 14 | 15 | 42 | 63 | 25 | | 0.84 | | |
| | 25 | 108 | 101.33 | 14 | 15 | 42 | 63 | 25 | | 0.88 | | |
| | 26 | 112 | 105.33 | 14 | 15 | 42 | 63 | 25 | | 0.92 | | |
| | 27 | 116 | 109.40 | 14 | 15 | 42 | 63 | 25 | | 0.96 | | |
| | 28 | 120 | 113.43 | 14 | 15 | 42 | 63 | 25 | | 1.00 | | |
| | 29 | 124 | 117.46 | 14 | 15 | 42 | 63 | 25 | | 1.00 | | |
| 30 | 128 | 121.50 | 14 | 15 | 42 | 63 | 25 | 1.10 | | | | |
| 32 | 137 | 129.57 | 14 | 15 | 45 | 68 | 28 | 1.30 | | | | |
| 34 | 145 | 137.64 | 14 | 15 | 45 | 68 | 28 | 1.30 | | | | |
| 35 | 149 | 141.68 | 14 | 15 | 45 | 68 | 28 | 1.40 | | | | |
| 36 | 153 | 145.72 | 16 | 17 | 45 | 68 | 28 | 1.50 | | | | |
| 40 | 169 | 161.87 | 16 | 17 | 45 | 68 | 28 | 1.70 | | | | |



Order Method

Sprocket No. and Quantity



Guide

* Since we also manufacture sizes other than those in the catalog, and machine shaft holes/keys/taps, etc., depending on your request, please contact our company's sales office for details.



Postage

Same-day shipping

* Please refer to P24 to P33 for the Semi-F Series <Complete Product> order method.