

SUS25B



SUS Stainless Steel Sprocket B-type

Order No. Example

SUS25B 12

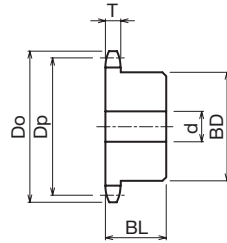
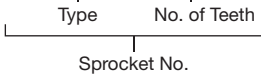

- Chain No.25
- Chain Pitch (P)6.35mm
- Bushing Link Inner Width (W)3.18mm
- Bushing Outside Diameter (Dr)3.30mm
- Tooth Width (T)2.8 mm

m Stainless Steel **GB304**

Type	No. of Teeth	Outer Diameter Do	Pitch Diameter Dp	Shaft Hole Diameter d			Boss Diameter BD	Boss Length BL	Shape	Weight kg	¥	Semi-F ¥
				Prepared Hole Product	Minimum	Maximum						
SUS 25B	10	23	20.55	6	7	8	13	14	Ground Specification	0.01		
	11	25	22.54	7	8	8	15	14		0.02		
	12	28	24.53	7	8	10	17	14		0.02		
	13	30	26.53	7	8	10	18	14		0.03		
	14	32	28.54	7	8	10	19	14		0.03		
	15	34	30.54	7	8	10	20	14		0.04		
	16	36	32.55	9	10	11	21	16		0.06		
	17	38	34.56	9	10	11	23	16		0.06		
	18	40	36.57	9	10	12	25	16		0.07		
	19	42	38.58	9	10	14	26	16		0.08		
	20	44	40.59	9	10	16	28	16		0.09		
	21	46	42.61	9	10	16	30	18		0.11		
	22	48	44.62	9	10	16	30	18		0.11		
	23	50	46.63	9	10	16	30	18		0.11		
	24	52	48.65	9	10	16	30	18		0.12		
	25	54	50.66	9	10	16	30	18		0.12		
	26	56	52.68	9	10	16	30	18		0.12		
	27	58	54.70	9	10	16	30	18		0.13		
	28	60	56.71	9	10	16	30	18		0.13		
30	64	60.75	9	10	16	30	18	0.14				
32	68	64.78	10	11	16	30	18	0.15				

* Please refer to P24 to P33 for the Semi-F Series <Complete Product> order method.



Order Method

Sprocket No. and Quantity



Guide

* Since we also manufacture sizes other than those in the catalog, and machine shaft holes/keys/taps, etc., depending on your request, please contact our company's sales office for details.



Postage

Same-day shipping