

# K25B

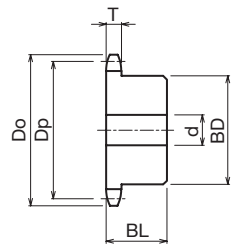

## Order No. Example

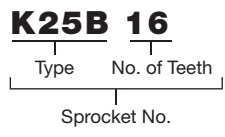

- Chain ..... No.25
- Chain Pitch ..... (P)6.35mm
- Bushing Link Inner Width ..... (W)3.18mm
- Bushing Outside Diameter ..... (Dr)3.30mm
- Tooth Width ..... (T)2.8 mm

**m** Carbon Structural Steel

Type	No. of Teeth	Outer Diameter Do	Pitch Diameter Dp	Shaft Hole Diameter d			Boss Diameter BD	Boss Length BL	Shape	Weight g	¥	Semi-F ¥
				Prepared Hole Product	Minimum	Maximum						
<b>K25B</b>	10	23	20.55	6	7	8.5	14	15	Ground Specification	30		
	11	25	22.54	7	8	8.5	15	15		30		
	12	28	24.53	7	8	9.5	15	15		30		
	13	30	26.53	7	8	10	18	15		50		
	14	32	28.54	7	8	10	20	15		50		
	15	34	30.54	7	8	10	20	15		50		
	16	36	32.55	9	10	12	25	15		60		
	17	38	34.56	9	10	12	25	15		70		
	18	40	36.57	9	10	12	25	15		70		
	19	42	38.58	9	10	16	28	15		80		
	20	44	40.59	9	10	16	28	15		80		
	21	46	42.61	9	10	16	28	15		90		
	22	48	44.62	9	10	16	30	15		100		
	23	50	46.63	9	10	16	30	15		110		
	24	52	48.65	9	10	16	30	15		120		
	25	54	50.66	9	10	20	35	15		140		
	26	56	52.68	9	10	20	35	15		140		
	27	58	54.70	9	10	20	35	15		150		
	28	60	56.71	9	10	20	35	15		150		
	29	62	58.73	9	10	20	35	15		160		
	30	64	60.75	9	10	20	35	15		160		
	31	66	62.77	10	11	22	40	20		200		
	32	68	64.78	10	11	22	40	20		200		
	33	70	66.80	10	11	22	40	20		210		
	34	72	68.82	10	11	22	40	20		210		
	35	74	70.84	10	11	22	40	20		210		
	36	76	72.86	10	11	22	40	20		220		
	37	78	74.88	10	11	22	40	20		260		
	38	80	76.90	10	11	22	40	20		260		
	39	82	78.91	10	11	22	40	20		270		