

SUSFBP11B

SUSFBP Finished Bore Sprocket Stainless Steel Round Tap Specification

Order No. Example

SUSFBP11B 16 D6

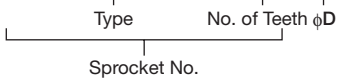

B-I-type

B-II-type

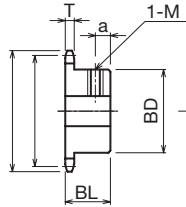
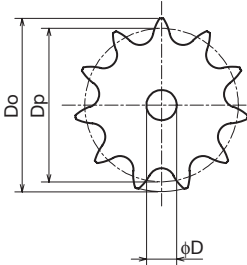

B-I Type

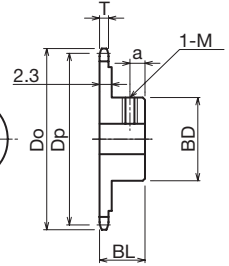

B-II Type

- Chain No.11
- Chain Pitch (P)3.7465mm
- Bushing Link Inner Width (W)1.83 mm
- Bushing Outside Diameter (Dr)2.285 mm
- Tooth Width (T)1.6 mm

Shaft Hole Machined Specification

| φD | Keyway bxt2 | Set Screw M |
|-------|----------------|-------------------|
| 5 - 7 | - | 3 |
| 8 - 9 | - | 4 |
| 10 | 3 x 1.4 | 4 |

 Stainless Steel  GB304

| Type | No. of Teeth | Type | φD ! Reference | Outer Diameter Do | Pitch Diameter Dp | Boss Diameter BD | Boss Length BL | a | Weight g | ¥ |
|---------------|--------------|-----------|-------------------|----------------------|----------------------|---------------------|-------------------|------|-------------|---|
| SUS FBP11B | 12 | B-I-type | 5 | 16.2 | 14.475 | 9.4 | 10.5 | 4 | 5.9 | |
| | 15 | | 5 6 | 19.9 | 18.020 | 13 | 10.5 | 4 | 11.5 | |
| | 16 | | 5 6 8 | 21.1 | 19.204 | 14 | 10.5 | 4 | 13.5 | |
| | 18 | | 5 6 8 | 23.5 | 21.575 | 16 | 10.5 | 4 | 17.7 | |
| | 20 | B-II-type | 8 10 | 25.9 | 23.949 | 19 | 10.5 | 4 | 23.3 | |
| | 24 | | 8 10 | 30.7 | 28.703 | 19 | 10.5 | 4 | 25.7 | |
| | 28 | | 8 10 | 35.5 | 33.462 | 19 | 10.5 | 4 | 28.7 | |
| | 30 | | 8 10 | 37.9 | 35.842 | 19 | 10.5 | 4 | 29.7 | |
| | 34 | | 8 10 | 42.7 | 40.604 | 19 | 10.5 | 4 | 37.9 | |
| | 36 | | 8 10 | 45.1 | 42.986 | 19 | 10.5 | 4 | 40.7 | |
| 40 | B-II-type | 8 10 | 49.8 | 47.751 | 19 | 10.5 | 4 | 46.5 | | |
| 48 | | 8 10 | 59.4 | 57.283 | 19 | 10.5 | 4 | 60.5 | | |



Sprocket No. φD and Quantity



* Since we also manufacture sizes other than those in the catalog, and machine shaft holes/keys/taps, etc., depending on your request, please contact our company's sales office for details.



Same-day shipping



* Finished Hole Tolerance
Less than φ8: H8
φ8 or more: H7