



**Thin-walled threaded insert**  
self-tapping, with cutting bores

**Ensat®-SBD**  
Works Standard  
347 0 and 348 0

**Application**

Threaded insert Ensat®-SBD with three cutting bores in a special thinwalled version developed primarily for applications with thin residual walls and for lightweight constructions. These version are designed primarily for processing on thread tapping machines, as the pitch of the outside and inside thread is identical.

For processing thinwalled inserts in metal, the tensile strength / hardness of the base material is always the determining factor. In critical cases, we recommend lubricating with suitable media in order to prevent fracture of the thinwalled inserts.

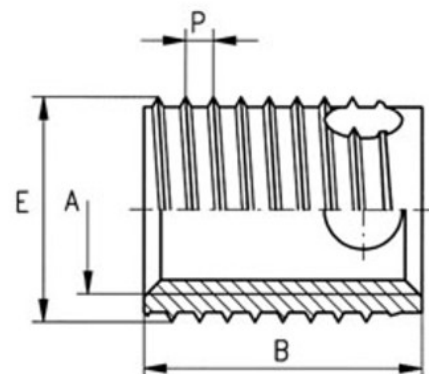

Dimensions in mm

Article number	Internal thread	External thread Special thread		Length	Guideline values for receiving hole diameter	Minimum borehole depth for blind holes
	A	E	P			
347 000 035 ...	M 3,5	5	0,6	5	4,7 to 4,8	7
348 000 035 ...	M 3,5	5	0,6	8	4,7 to 4,8	10
347 000 040 ...	M 4	6	0,7	6	5,6 to 5,7	8
348 000 040 ...	M 4	6	0,7	8	5,6 to 5,7	10
347 000 050 ...	M 5	6,5	0,8	7	6,1 to 6,2	9
348 000 050 ...	M 5	6,5	0,8	10	6,1 to 6,2	13
347 000 060 ...	M 6	8	1	8	7,5 to 7,7	10
348 000 060 ...	M 6	8	1	12	7,5 to 7,7	15
347 000 080 ...	M 8	10	1,25	9	9,4 to 9,6	11
348 000 080 ...	M 8	10	1,25	14	9,4 to 9,6	17
347 000 100 ...	M 10	12	1,5	10	11,2 to 11,5	13
348 000 100 ...	M 10	12	1,5	18	11,2 to 11,5	22
347 000 120 ...	M 12	14	1,75	12	13,2 to 13,5	15
348 000 120 ...	M 12	14	1,75	22	13,2 to 13,5	26

**Example for finding the article number**

Self-tapping thin-walled threaded insert Ensat®-SBD to Works Standard 347 0 with internal thread A = M5 made of case-hardened, zinc plated, thick film passivated steel: Ensat®-SBD 347 000 050.112

**Short design**  
**Long design**

Works Standard 347  
Works Standard 348

**Materials**

Case-hardened steel, zinc plated, blue passivated  
Case-hardened steel, zinc plated, thick film passivated  
Case-hardened steel, zinc-nickel plated, transparent passivated  
Stainless steel 1.4305 (M3,5 to M8)

Article no. (fourth group of digits) ... .. 110  
Article no. (fourth group of digits) ... .. 112  
Article no. (fourth group of digits) ... .. 143  
Article no. (fourth group of digits) ... .. 500

**Other materials, designs and finishes on request.**

**Tolerance**

ISO 2768-m

**Thread**

Internal thread A: as per ISO 6H  
External thread E: Special thread with flattened thread root, as per KKV standard  
Internal thread UNC, UNF, Whitworth on request