

LKF / LKK

PLASTIC KNURLED TORQUE KNOBS



ELESA Original Design B. 259



LKF

(Tapped, Black)



LKF-CL

(Tapped, White)



LKK

(Stud, Black)

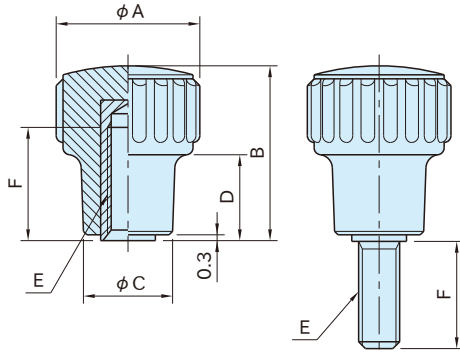

LKF LKF-CL

(Tapped)

LKK

(Stud)

Type	Knob	Insert	Stud
LKF	Phenolic plastic Glossy Finish Black	Brass	-
LKK	-	-	Steel (SUM22L) Zinc plated
LKF-CL	Phenolic plastic Glossy Finish White	Stainless steel (SUS303)	-

LKF (Tapped, Black, Brass Insert)

Part Number	A	B	C	D	E	F	Weight (g)
LKF20A	21	25	13	12	M 5×0.8	16	12
LKF20					M 6×1		11
LKF25A	26	28	16	15	M 8×1.25		18
LKF25					M 10×1.5	19	
LKF30	31	32	19	17	M10×1.5	17	29

LKF-CL (Tapped, White, S.Steel Insert)

Part Number	A	B	C	D	E	F	Weight (g)
LKF20CL	21	25	13	12	M 6×1	12	11
LKF25CL	26	28	16	15	M 8×1.25	13	19
LKF30CL	31	32	19	17	M10×1.5	17	29

LKK (Stud, Black)

Part Number	A	B	C	D	E	F	Weight (g)
LKK20×16	21	25	13	12	M 6×1	16	13
LKK25×20	26	28	16	15	M 8×1.25	20	25
LKK30×25	31	32	19	17		25	38

- Working temperature : Between -20°C and 110°C for **LKF** and **LKK** types
Between -20°C and 90°C for **LKF-CL** type