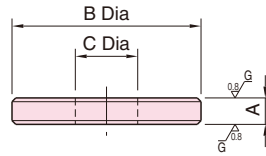
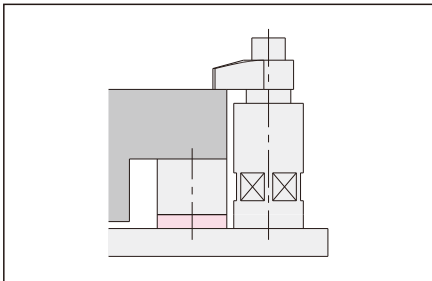

**BJ623****SPACERS**

Material : S45C steel  
 Heat Treat : Quenched and tempered  
 Finish : Black oxide  
 Precision ground

Part Number	A ( $^{+0.01}$ 0)	B	C	Weight (g)
<b>BJ623-08001</b>	5	25	8.4	21
<b>BJ623-08002</b>		35		35
<b>BJ623-08003</b>	10	25		43
<b>BJ623-08004</b>		35		70
<b>BJ623-10001</b>	5	30	10.5	24
<b>BJ623-10002</b>		40		46
<b>BJ623-10003</b>	10	30		48
<b>BJ623-10004</b>		40		90
<b>BJ623-12001</b>	5	40	13	44
<b>BJ623-12002</b>		50		70
<b>BJ623-12003</b>	10	40		85
<b>BJ623-12004</b>		50		145
<b>BJ623-16001</b>	5	50	17	65
<b>BJ623-16002</b>		60		100
<b>BJ623-16003</b>	10	50		135
<b>BJ623-16004</b>		60		200

**How To Use****Feature:**

Precision ground on both top and bottom faces