

4-Bolt Flange Units

UKF

Tapered bore (with adapter)

d_1 20 ~ (50) mm

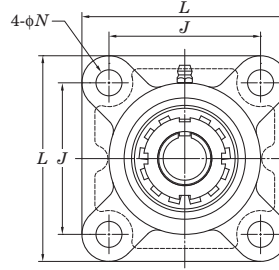
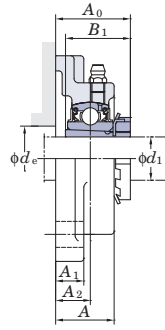

Shaft Dia. mm inch	d_1	Dimensions inch mm									Bolt Size inch mm	Standard		
		L	A	J	N	A_1	A_2	A_0	B_1	d_e (min.)		Unit No.	Housing No.	Bearing No.
20	3/4	3 3/4 95	1 1/16 27	2 3/4 70	15/32 12	1/2 13	5/8 16	1 13/32 36	1 3/8 35	1 3/16 30	3/8 M10	UKF205	F205	UK205
	3/4	4 1/4 108	1 3/16 30	3 17/64 83	15/32 12	1/2 13	45/64 18	1 9/16 39.5	1 3/8 35	1 3/16 30	3/8 M10	UKFX05	FX05	UKX05
	3/4	4 11/32 110	1 5/32 29	3 5/32 80	5/8 16	1/2 13	5/8 16	1 15/32 37.5	1 3/8 35	—	1/2 —	M14	UKF305	F305
25	1	4 1/4 108	1 7/32 31	3 17/64 83	15/32 12	1/2 13	45/64 18	1 9/16 39.5	1 1/2 38	1 13/32 36	3/8 M10	UKF206	F206	UK206
	1	4 19/32 117	1 11/32 34	3 5/8 92	5/8 16	9/16 14	3/4 19	1 21/32 42	1 1/2 38	1 13/32 36	1/2 M14	UKFX06	FX06	UKX06
	1	4 29/32 125	1 1/4 32	3 47/64 95	5/8 16	19/32 15	45/64 18	1 5/8 41	1 1/2 38	—	1/2 —	M14	UKF306	F306
30	1 1/8	4 19/32 117	1 11/32 34	3 5/8 92	35/64 14	19/32 15	3/4 19	1 11/16 43	1 11/16 43	1 5/8 41	7/16 M12	UKF207	F207	UK207
	1 1/8	5 1/8 130	1 1/2 38	4 1/64 102	5/8 16	9/16 14	53/64 21	1 27/32 47	1 11/16 43	1 5/8 41	1/2 M14	UKFX07	FX07	UKX07
	1 1/8	5 5/16 135	1 13/32 36	3 15/16 100	3/4 19	5/8 16	25/32 20	1 25/32 45.5	1 11/16 43	—	5/8 —	M16	UKF307	F307
35	1 1/4	5 1/8 130	1 13/32 36	4 1/64 102	5/8 16	19/32 15	53/64 21	1 7/8 48	1 13/16 46	1 13/16 46	1/2 M14	UKF208	F208	UK208
	1 1/4	5 13/32 137	1 9/16 40	4 9/64 105	3/4 19	9/16 14	55/64 22	1 31/32 50	1 13/16 46	1 13/16 46	5/8 M16	UKFX08	FX08	UKX08
	1 1/4	5 29/32 150	1 9/16 40	4 13/32 112	3/4 19	21/32 17	29/32 23	2 50.5	1 13/16 46	—	5/8 —	M16	UKF308	F308
40	1 1/2	5 13/32 137	1 1/2 38	4 9/64 105	5/8 16	5/8 16	55/64 22	2 51	1 31/32 50	2 1/16 52	1/2 M14	UKF209	F209	UK209
	1 1/2	5 5/8 143	1 9/16 40	4 3/8 111	3/4 19	9/16 14	29/32 23	2 1/16 52	1 31/32 50	2 1/16 52	5/8 M16	UKFX09	FX09	UKX09
	1 1/2	6 5/16 160	1 23/32 44	4 59/64 125	3/4 19	23/32 18	63/64 25	2 5/32 55	1 31/32 50	—	5/8 —	M16	UKF309	F309
45	1 3/4	5 5/8 143	1 9/16 40	4 3/8 111	5/8 16	5/8 16	55/64 22	2 1/16 52	2 5/32 55	2 9/32 58	1/2 M14	UKF210	F210	UK210
	1 3/4	6 3/8 162	1 23/32 44	5 1/8 130	3/4 19	25/32 20	1 1/32 26	2 9/32 58	2 5/32 55	2 9/32 58	5/8 M16	UKFX10	FX10	UKX10
	1 3/4	6 7/8 175	1 7/8 48	5 13/64 132	29/32 23	3/4 19	1 7/64 28	2 3/8 60	2 5/32 55	—	3/4 —	M20	UKF310	F310
50	1 7/8	6 3/8 162	1 11/16 43	5 1/8 130	3/4 19	23/32 18	63/64 25	2 1/4 57.5	2 5/16 59	2 17/32 64	5/8 M16	UKF211	F211	UK211
	2	6 7/8 175	1 15/16 49	5 5/8 143	3/4 19	25/32 20	1 9/64 29	2 17/32 64.5	2 5/16 59	2 17/32 64	5/8 M16	UKFX11	FX11	UKX11
	2	—	—	—	—	—	—	—	—	—	—	—	—	—

- Remarks
- In Part No. of unit and units with covers, fitting codes follow bore diameter numbers. (See Table 10.5 in P.62.)
 - Part No. of applicable grease fittings are shown below.
 A-1/4-28UNF 205~210, X05~X09, 305~308
 A-R1/8..... 211~218, X10~X20, 309~328