

15MPa B型銅管くい込継手
(150kgf/cm²)

GS-1

FEMAL CONNECTOR

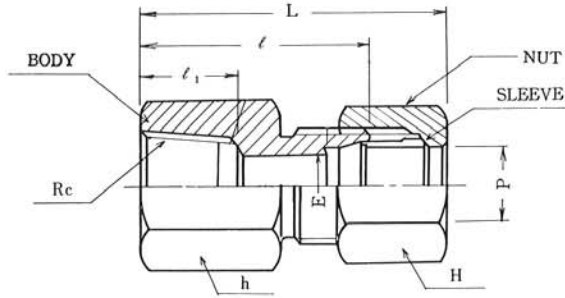

(注) L寸法はナットを締付け前の概略寸法を示す。

L denotes the rough dimensions before tightening the nuts. 単位：mm

| 継手の呼称 Designation of joints | 各 部 の 記 号 Symbols of respective parts | 適用する 管の外径 Tube(O.D) P | Minimum Opening E | 六角対辺 Opposite sides of hexagon | | ℓ ₁ | ℓ | (約) Approx L | Rc (PT) | 1組分 Wt Weight per set (kg) |
|--------------------------------|---|--------------------------------|-------------------------|-----------------------------------|----|----------------|----|--------------------|-----------------------------|----------------------------------|
| | | | | h | H | | | | | |
| GS-1 | 4-Rc ¹ / ₈ -B | 4 | 2.5 | 14 | 12 | 10 | 21 | 29 | ¹ / ₈ | 0.026 |
| GS-1 | 4-Rc ¹ / ₄ -B | 4 | 2.5 | 19 | 12 | 14 | 26 | 31 | ¹ / ₄ | 0.039 |
| GS-1 | 6-Rc ¹ / ₈ -B | 6 | 4 | 14 | 14 | 10 | 25 | 34.5 | ¹ / ₈ | 0.033 |
| GS-1 | 6-Rc ¹ / ₄ -B | 6 | 4 | 19 | 14 | 14 | 30 | 38.5 | ¹ / ₄ | 0.051 |
| GS-1 | 6-Rc ³ / ₈ -B | 6 | 4 | 23 | 14 | 15 | 32 | 39.5 | ³ / ₈ | 0.063 |
| GS-1 | 8-Rc ¹ / ₈ -B | 8 | 6 | 17 | 17 | 10 | 25 | 36 | ¹ / ₈ | 0.041 |
| GS-1 | 8-Rc ¹ / ₄ -B | 8 | 6 | 19 | 17 | 14 | 30 | 41 | ¹ / ₄ | 0.059 |
| GS-1 | 8-Rc ³ / ₈ -B | 8 | 6 | 23 | 17 | 15 | 32 | 43 | ³ / ₈ | 0.071 |
| GS-1 | 10-Rc ¹ / ₄ -B | 10 | 6 | 19 | 19 | 14 | 30 | 42.5 | ¹ / ₄ | 0.066 |
| GS-1 | 10-Rc ³ / ₈ -B | 10 | 8 | 23 | 19 | 15 | 32 | 44.5 | ³ / ₈ | 0.077 |
| GS-1 | 12-Rc ³ / ₈ -B | 12 | 10 | 23 | 21 | 15 | 32 | 44.5 | ³ / ₈ | 0.083 |
| GS-1 | 12-Rc ¹ / ₂ -B | 12 | 10 | 29 | 21 | 19 | 36 | 48.5 | ¹ / ₂ | 0.140 |
| GS-1 | 14-Rc ³ / ₈ -B | 14 | 10 | 23 | 26 | 15 | 34 | 46.5 | ³ / ₈ | 0.116 |
| GS-1 | 14-Rc ¹ / ₂ -B | 14 | 11 | 29 | 26 | 19 | 38 | 50.5 | ¹ / ₂ | 0.163 |
| GS-1 | 15-Rc ³ / ₈ -B | 15 | 12 | 23 | 26 | 15 | 34 | 46.5 | ³ / ₈ | 0.117 |
| GS-1 | 15-Rc ¹ / ₂ -B | 15 | 12 | 29 | 26 | 19 | 38 | 50.5 | ¹ / ₂ | 0.165 |
| GS-1 | 16-Rc ¹ / ₂ -B | 16 | 13 | 29 | 29 | 19 | 38 | 51.5 | ¹ / ₂ | 0.183 |
| GS-1 | 18-Rc ¹ / ₂ -B | 18 | 14 | 29 | 32 | 19 | 38 | 51.5 | ¹ / ₂ | 0.200 |
| GS-1 | 18-Rc ³ / ₄ -B | 18 | 15 | 35 | 32 | 21 | 41 | 54.5 | ³ / ₄ | 0.240 |
| GS-1 | 20-Rc ¹ / ₂ -B | 20 | 17 | 29 | 35 | 19 | 38 | 50.5 | ¹ / ₂ | 0.224 |
| GS-1 | 20-Rc ³ / ₄ -B | 20 | 17 | 35 | 35 | 21 | 41 | 53.5 | ³ / ₄ | 0.264 |
| GS-1 | 22-Rc ¹ / ₂ -B | 22 | 13 | 35 | 36 | 19 | 38 | 50.5 | ¹ / ₂ | 0.229 |
| GS-1 | 22-Rc ³ / ₄ -B | 22 | 18 | 35 | 36 | 21 | 41 | 53.5 | ³ / ₄ | 0.267 |
| GS-1 | 25-Rc ³ / ₄ -B | 25 | 20 | 41 | 41 | 21 | 41 | 54.5 | ³ / ₄ | 0.387 |
| GS-1 | 25-Rc 1-B | 25 | 20 | 41 | 41 | 24 | 45 | 58.5 | 1 | 0.417 |
| GS-1 | 30-Rc 1-B | 30 | 25 | 41 | 46 | 24 | 47 | 61.5 | 1 | 0.478 |