

Panel-mount socket SLB4-G...

Insulated, rigid, Ø 4 mm, accepting spring-loaded Ø 4 mm plugs with rigid insulating sleeve. Machined brass. The socket

is screwed into pre-drilled panels of plastic, metal, etc. **Connection: Threaded bolt M4 and soldering hole.**

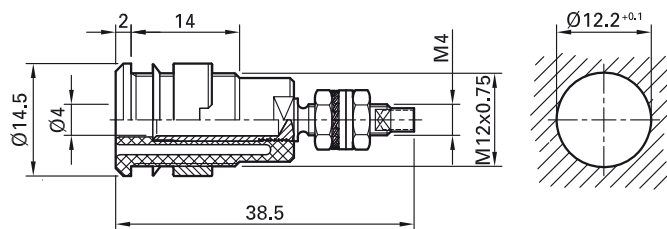

Order No.	Type	Rated voltage/current		*Standard colors										
23.3020-*	SLB4-G	1000 V, CAT III / 32 A	Au c	<table border="1"> <tr> <td>20</td><td>21</td><td>22</td><td>23</td><td>24</td> </tr> <tr> <td>25</td><td>26</td><td>27</td><td>28</td><td>29</td> </tr> </table>	20	21	22	23	24	25	26	27	28	29
20	21	22	23	24										
25	26	27	28	29										
49.7043-*	SLB4-G/N-X	1000 V, CAT III / 32 A	Ni c	<table border="1"> <tr> <td>20</td><td>21</td><td>22</td><td>23</td><td>24</td> </tr> <tr> <td>25</td><td>26</td><td>27</td><td>28</td><td>29</td> </tr> </table>	20	21	22	23	24	25	26	27	28	29
20	21	22	23	24										
25	26	27	28	29										

Supplied assembly material

Page 166	MU0,8D/M4	2 hexagon nuts, suitable for	SLB4-G
Page 166	MU0,8D/M4N	2 hexagon nuts, suitable for	SLB4-G/N-X
Page 167	MUR/M12x0,75	Round nut, suitable for	SLB4-G, SLB4-G/N-X
Page 167	SSP4	Washer, suitable for	SLB4-G
Page 167	U/M4	2 washers, suitable for	SLB4-G
Page 168	FS/M4	Spring washer, suitable for	SLB4-G



Tube spanners SS2, SS425, page 170



Assembly instructions MA152

www.staubli.com/electrical